

## For General Industrial and Plumbing Applications

Job Name \_\_\_\_\_ Contractor \_\_\_\_\_  
 Job Location \_\_\_\_\_ Approval \_\_\_\_\_  
 Engineer \_\_\_\_\_ Contractor P.O. No. \_\_\_\_\_  
 Approval \_\_\_\_\_ Representative \_\_\_\_\_

# Series 6/P-6 MIDI Check Valves

Series 6 will operate efficiently in silence all of the functions of a swing check or vertical lift check valve. These are not suggested for installation in sewage ejector piping.

Series P-6 is a 1/4" (8 mm) NPT plastic check valve.

### FEATURES

#### Series 6

- ✦ Elastomer seat
- ✦ Installation in horizontal or vertical position
- ✦ Low pressure drop; low opening pressure
- ✦ Positive back stop
- ✦ Brass body

#### Series P-6

- ✦ Plastic check valve
- ✦ Extremely low cracking pressure
- ✦ Full flow capabilities
- ✦ Bubble-tight seating
- ✦ Corrosion-resistant
- ✦ NSF approved grade acetal body

### APPLICATIONS

General Industrial and Plumbing  
 OEM applications

Warning: Do not use for reciprocating air compressor service.

### PRESSURE - TEMPERATURE

#### Series 6

Pressure: 200 psi (13.8 bars)

Maximum temperature: 180°F (82° C)

#### Series P-6

Pressure: 235 psi (16.2 bars)

Maximum temperature: 150°F (66°C)

### SIZES - CONNECTIONS

NPT threaded connections

Series 6 Female X Female only

Sizes: 1/4", 3/8", 1/2", 3/4", 1" (8, 10, 15, 20, 25 mm)

Series P-6

Sizes: 1/4" (8 mm)

To order P-6 check valves, use the following:

01 for F x F (female x female)

02 for M x F (male x female)

03 for M x M (male x male)

Example: 1/4" P6-03

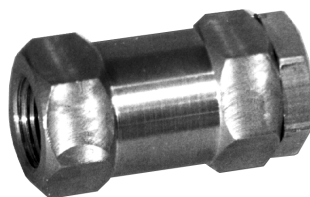

Watts 6  
1/4" - 3/8" (8-10mm)

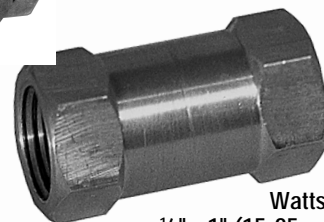

Watts 6  
1/2" - 1" (15-25mm)

### Watts P6 Series

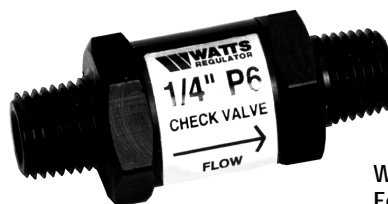

Watts P6  
Male x Male

Watts P6  
Female x Female



Unique Positive Check Module

A LEADER IN VALVE TECHNOLOGY



Since 1874

Watts Industries, Inc.

Water Products Division • Safety & Control Valves

USA: 815 Chestnut St., No. Andover, MA 01845-6098; www.wattsreg.com  
 Canada: 5435 North Service Rd., Burlington, ONT. L7L 5H7; www.wattscca.com

# DIMENSIONS-WEIGHT

6 - Sizes: 1/4" - 3/8" (8-10mm)

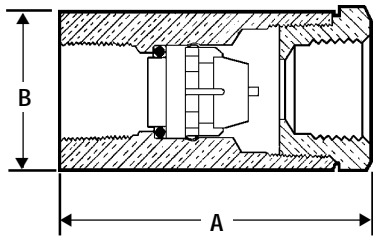

6 - Sizes: 1/2" - 1" (15-25mm)

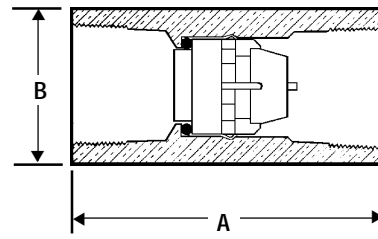

Direction of Flow →

1/4" P6-01 - Female x Female

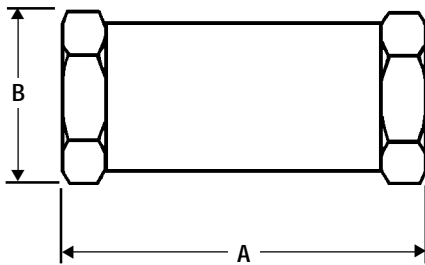

1/4" P6-02 - Male x Female

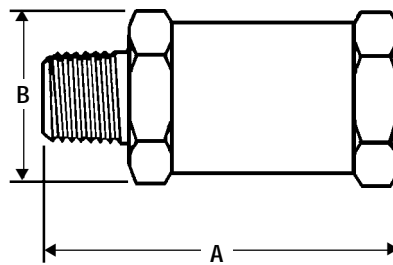

1/4" P6-03 - Male x Male

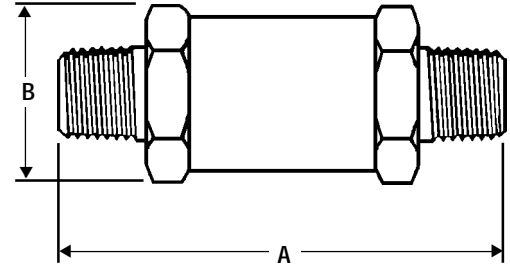

Model	Size (DN)		Dimensions (approx.)				Weight	
	in.	mm	A		B		lbs.	kgs.
6	1/4	8	2	50	1	25	.31	.14
6	3/8	10	2	50	1	25	.31	.14
6	1/2	15	2	50	1	25	.31	.14
6	3/4	20	2 1/2	64	1 1/4	32	.63	.28
6	1	25	3	76	1 1/2	38	.88	.40
P6 (01/02)	1/4	8	2 1/8	54	1	25	.31	.14
P6 (03)	1/4	8	2 5/8	67	1	25	.31	.14

## Cv RATING

Model	Size (DN)		Orifice		Cv
	In.	mm	In.	mm	
6	1/4	8	3/8	10	5.9
6	3/8	10	3/8	10	5.9
6	1/2	15	3/8	10	5.9
6	3/4	20	1/2	13	11.5
6	1	25	5/8	16	17.2
P6	1/4	8	3/8	10	5.9

Watts product specifications in U.S. customary units and metric are approximate and are provided for reference only. For precise measurements, please contact Watts Technical Service. Watts reserves the right to change or modify product design, construction, specifications, or materials without prior notice and without incurring any obligation to make such changes and modifications on Watts products previously or subsequently sold.



USA: 815 Chestnut St., No. Andover, MA 01845-6098; [www.wattsreg.com](http://www.wattsreg.com)  
 Canada: 5435 North Service Rd., Burlington, ONT. L7L 5H7; [www.wattscda.com](http://www.wattscda.com)

