



T&S BRASS AND BRONZE WORKS, INC.

2 Saddleback Cove / P.O. Box 1088
Travelers Rest, SC 29690

Model No.

BL-5709-01

Item No.

Travelers Rest, SC: 800-476-4103 • Simi Valley, CA: 800-423-0150 • Fax: 864-834-3518 • www.tsbrass.com



ADA Compliant

This Space for Architect/Engineer Approval

Job Name _____ Date _____

Model Specified _____ Quantity _____

Customer/Wholesaler _____

Contractor _____

Architect/Engineer _____

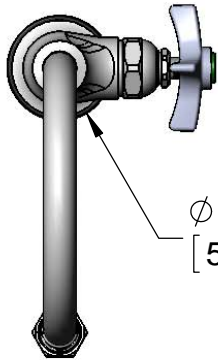

ϕ 2 3/16"
[56mm]

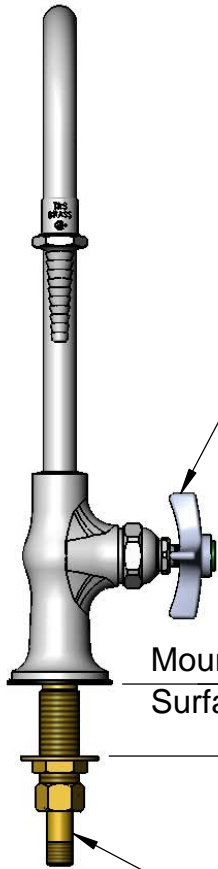

Eterna Cartridge
w/ 4-Arm Handle
& Color Coded
Index

1 1/2" Max.
[38mm]

Mounting
Surface

150A
Tailpiece & Nut
Included For Optional
1/4" NPT Connection

14 1/8"
[359mm]

Rigid Gooseneck w/
B-0198 Serrated Tip
w/ Washer

5 5/8"
[144mm]

7 1/8"
[181mm]

2 11/16"
[68mm]

2 7/16"
[61mm]

1/2" NPSM Male Inlet
w/o 150A Tailpiece &
Nut Installed

Rough-In Requirement:
 ϕ 1" [25mm] Hole

Product Specifications:
Single Temperature Lab Faucet w/ Rigid Gooseneck, Serrated Tip,
4-Arm Lab Handle & 1/2" NPT Male Shank Inlet

Drawn

DMH

Checked

KJG

Approved

JHB

Scale:

1:4

Date:

06/28/12



T&S BRASS AND BRONZE WORKS, INC.

2 Saddleback Cove / P.O. Box 1088

Travelers Rest, SC 29690

Model No.

BL-5709-01

Item No.

Travelers Rest, SC: 800-476-4103 • Simi Valley, CA: 800-423-0150 • Fax: 864-834-3518 • www.tsbrass.com

ITEM NO.	SALES NO.	DESCRIPTION
1	B-0198	Serrated Tip w/ Washer
2	001051-45	Washer
3	005960-40	Eterna Cartridge - RTC
4	000059-40	4-Arm Lab Handle
5	001191-45	Green CW Snap-In Index
6	000925-45	Lab Handle Screw
7	144L	Gasket Polypropylene
8	000999-45	Brass Lock Washer
9	002954-45	Shank Lock Nut
10	150A	Bag of (1) Tailpiece & (1) Nut

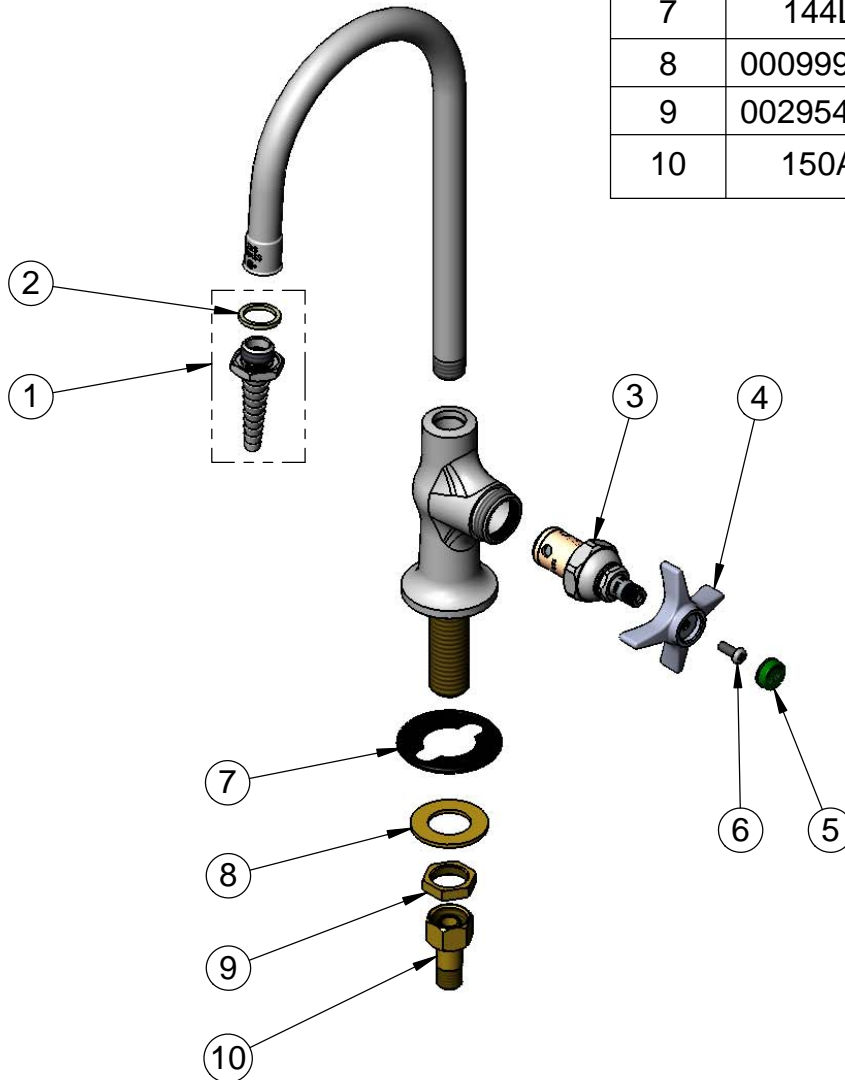

Product Specifications:

Single Temperature Lab Faucet w/ Rigid Gooseneck, Serrated Tip, 4-Arm Lab Handle & 1/2" NPT Male Shank Inlet

Drawn

DMH

Checked

KJG

Approved

JHB

Scale:

NTS

Date:

06/28/12