



# T&S BRASS AND BRONZE WORKS, INC.

2 Saddleback Cove / P.O. Box 1088  
Travelers Rest, SC 29690

Model No.

**B-1480**

Item No.

Travelers Rest, SC: 800-476-4103 • Simi Valley, CA: 800-423-0150 • Fax: 864-834-3518 • www.tsbrass.com

This Space for Architect/Engineer Approval

Job Name \_\_\_\_\_ Date \_\_\_\_\_

Model Specified \_\_\_\_\_ Quantity \_\_\_\_\_

Customer/Wholesaler \_\_\_\_\_

Contractor \_\_\_\_\_

Architect/Engineer \_\_\_\_\_

B-0963  
Continuous Pressure  
Vacuum Breaker  
w/ Integral  
Check Valve

1/2" NPT x 36"  
Flexible Water  
Connector to  
Hose Reel

1/2" NPT x 32" Riser

Stainless Steel  
Quick Disconnect

Control Valve

1/2" NPT x 18" Riser

(2) B-0110  
Wall Brackets

12 5/8"  
[321mm]

Ø 2" [51mm]  
Flanges w/  
1/2" NPT  
Female Inlets

Adjustable From  
7 3/4" to 8 1/4"  
[197mm to 210mm]

Open Stainless Steel Hose Reel  
w/ 50' of 1/2" Hose

019653-40  
1/2" NPT  
Live Swivel

Front Trigger  
Water Gun

Quarter-Turn  
Eterna Cartridges  
w/ Spring Checks  
& Lever Handles  
w/ Color Coded  
Indexes

Ø 1/2"  
[13mm]  
Typ

6"  
[152mm]

3 11/16"  
[94mm]

1/2"  
[13mm]  
Typ

6 3/16"  
[158mm]

3 1/8"  
[79mm]

7 9/16"  
[193mm]

13/16"  
[21mm]

56 1/4"  
[1429mm]

19 7/16"  
[494mm]

2 3/8"  
[61mm]

**Product Specifications:**

Open Stainless Steel Hose Reel w/ 50' of 1/2" Hose, Front Trigger Water Gun w/ Swivel, 1/2" NPT Vacuum Breaker, 1/2" NPT Flexible Water Connector, 8" Wall Mount Mixing Faucet & Control Valve

**Product Compliance:**

NSF 61 Exempt (Non-Potable)  
2019 DOE PRSV Non-Compliant  
ASSE 1056 (VB)



**T&S BRASS AND BRONZE WORKS, INC.**  
 2 Saddleback Cove / P.O. Box 1088  
 Travelers Rest, SC 29690

Model No.  
**B-1480**  
 Item No.

Travelers Rest, SC: 800-476-4103 • Simi Valley, CA: 800-423-0150 • Fax: 864-834-3518 • www.tsbrass.com

| ITEM NO. | SALES NO.   | DESCRIPTION   |
|----------|-------------|---|
| 1        | 013988-40NS | 8" Wall Mount Mixing Faucet                             |
| 2        | 013963-40   | 1/2" NPT x 18" Riser                                    |
| 3        | 002900-40NS | 1/2" NPT Shut-Off Control Valve, Polished Chrome        |
| 4        | 017260-40   | 1/2" NPT x 32" Riser                                    |
| 5        | B-0963      | 1/2" NPT Continuous Pressure VB w/ Integral Check Valve |
| 6        | HW-2C-36    | 1/2" NPT x 36" Flexible Water Hose                      |
| 7        | B-0110      | 6" Wall Bracket   |
| 8        | AW-5C       | 1/2" NPT Quick Disconnect                               |
| 9        | 002534-25   | 1/2" NPT Close Nipple                                   |
| 10       | B-7143-05   | Open Stainless Steel Hose Reel w/ 50' of 1/2" Hose      |
| 11       | MV-2522-24  | Stainless Steel Water Gun, Front Trigger                |
| 12       | 015073-40   | Check Valve w/ 1/2" NPT Adapter                         |
| 13       | 019653-40   | 1/2" NPT Live Swivel                                    |

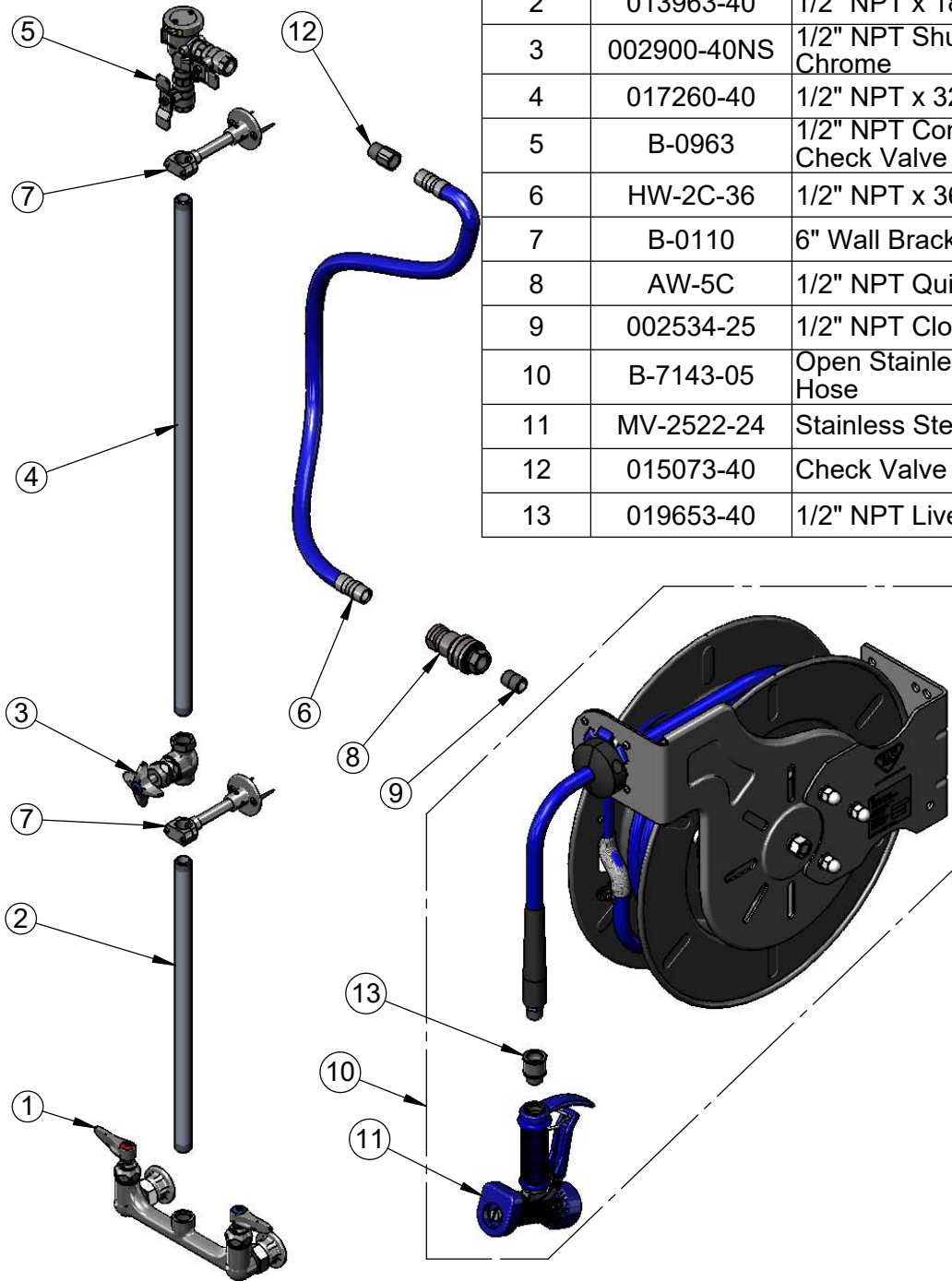

**Product Specifications:**  
 Open Stainless Steel Hose Reel w/ 50' of 1/2" Hose, Front Trigger Water Gun w/ Swivel, 1/2" NPT Vacuum Breaker, 1/2" NPT Flexible Water Connector, 8" Wall Mount Mixing Faucet & Control Valve

**Product Compliance:**  
 NSF 61 Exempt (Non-Potable)  
 2019 DOE PRSV Non-Compliant  
 ASSE 1056 (VB)