

**111950  
(CONCEALED LATCH)**

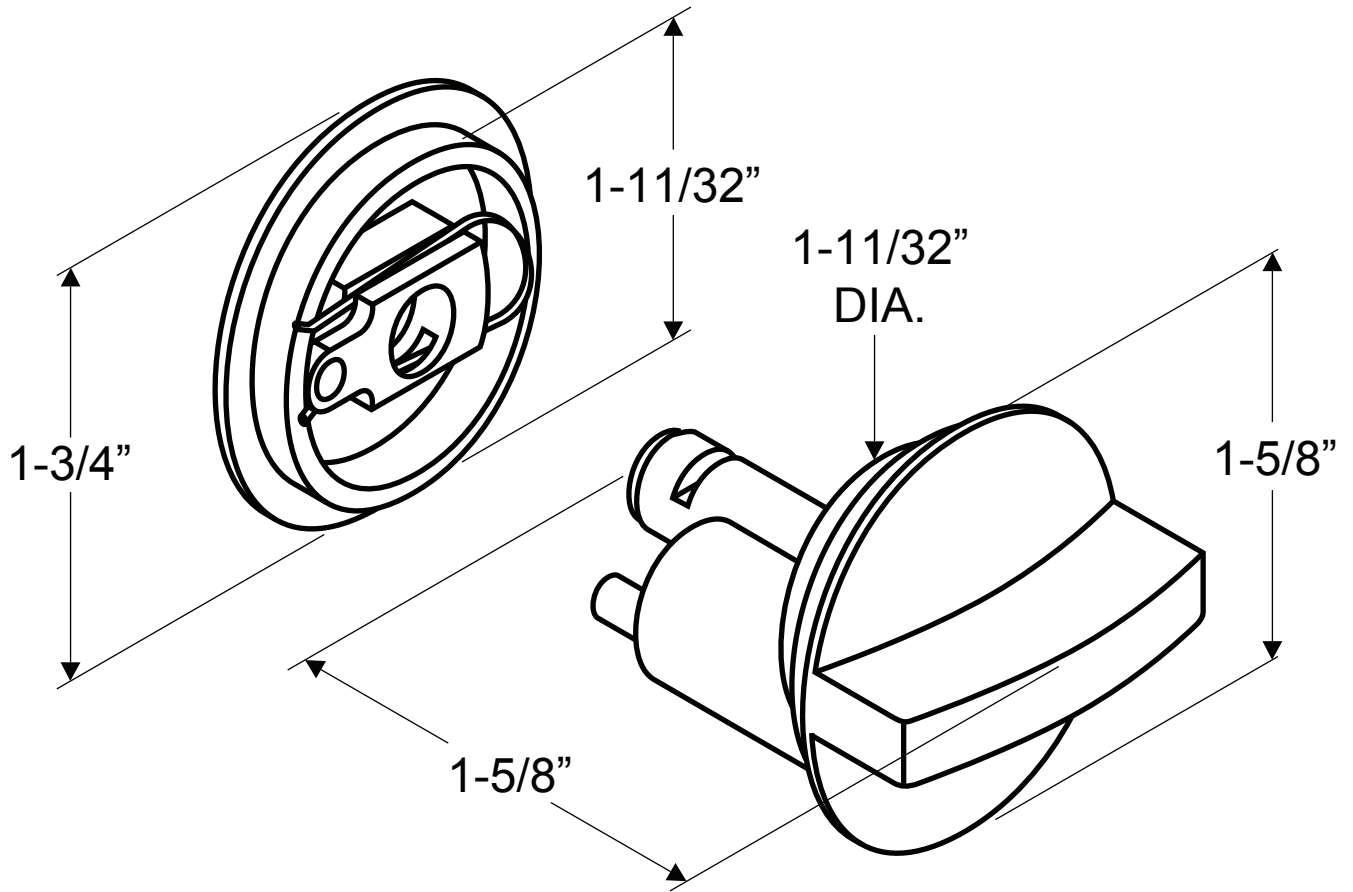

# INSTRUCTIONS FOR INSTALLING 6160, 6170, 111950 (CONCEALED LATCHES)

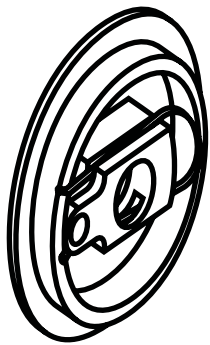

**#111950**

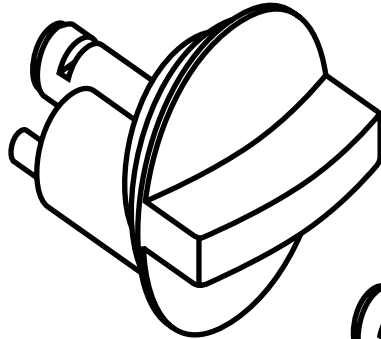

**#6160**

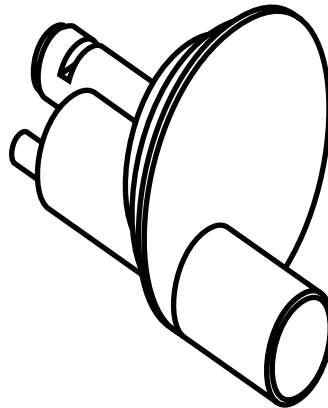

**#6170**

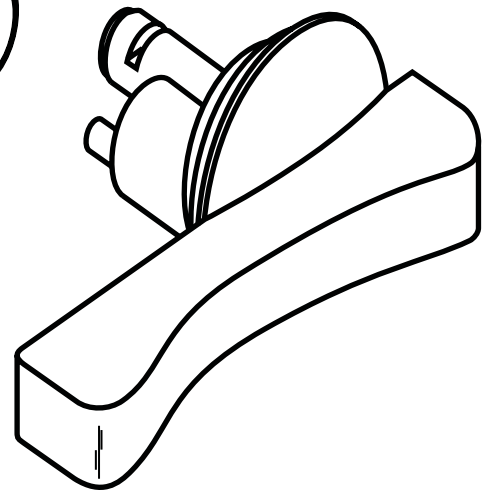

1. Insert male knob on inside of door.
3. Insert female knob on outside of door.
3. Engage both knobs until retaining ring “clicks” into groove (they will not come apart).

**REMOVAL - To remove latch, drill 3/8” diameter hole through center of female knob (outside) 5/8” deep. Pull knob set apart.**

