

TruSaber & Saber Parts Breakdown

S402 / S452
(Valves with 1" supply)

S402-3 / S452-3
(Valves with 1" supply)

S402-1.6 / S452-1.5
(Valves with 1" supply)

S402-1.28 / 1.1
(Valves with 1" supply)

S451-1 / S451-0.5 / 0.125
(Valves with 3/4" supply)

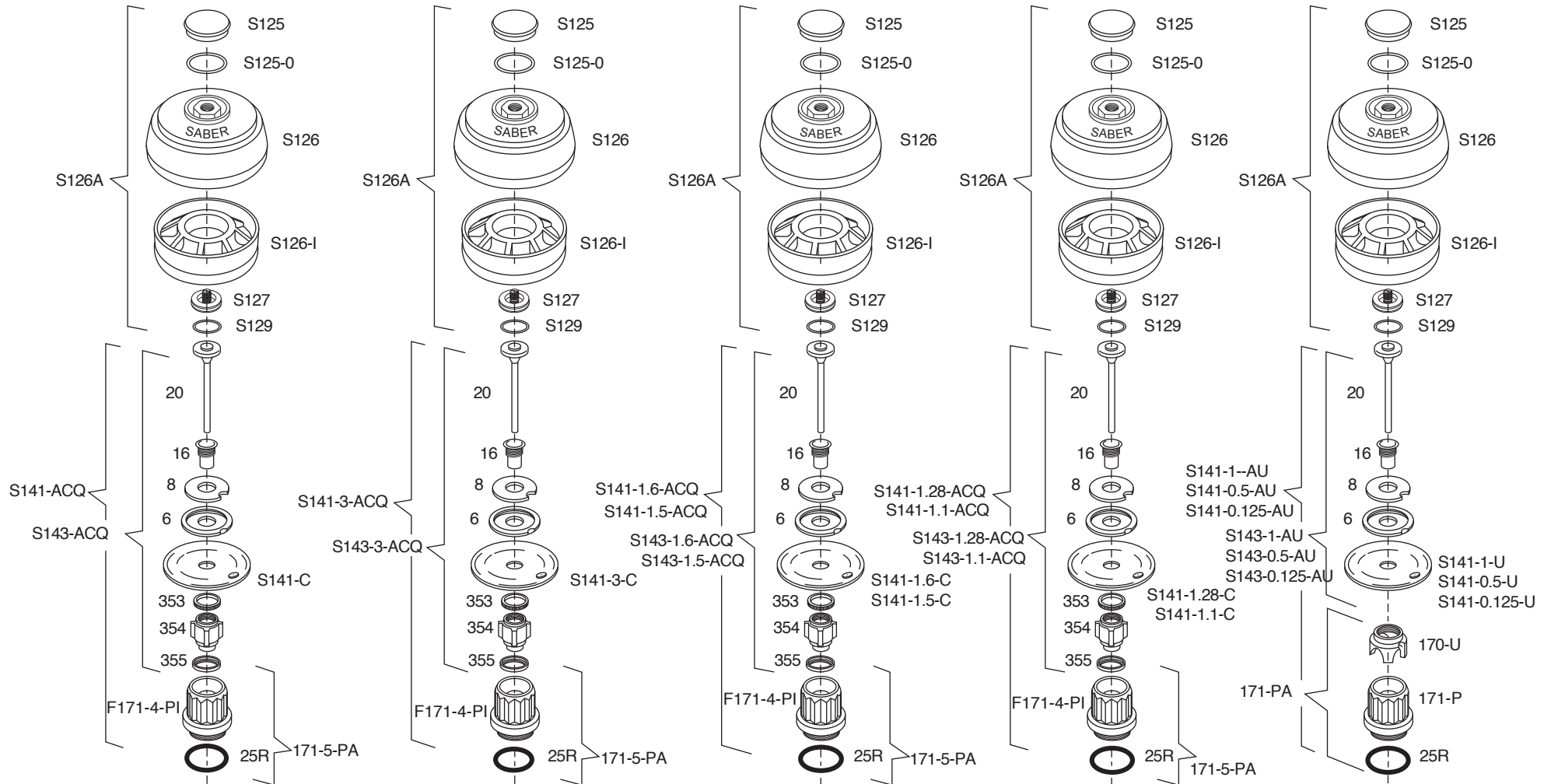

♦ F180

180 part and 186 part supplied in valves with non hold open feature must be used together. For complete diaphragm operating assembly with non hold open feature, order as applicable:
 S141-ACQ-T5
 S141-3-ACQ-T5
 S141-1.6-ACQ-T5
 S141-1-AU-T5
 For complete handle assembly for non hold open feature, order 333A-T5

