



S19314 Series

European and Australian Drench Shower and Halo Eyewash or Eye/Face Wash

- Halo™ and SpinTec™ Deliver the Most Effective Shower and Eye/Face Washdown Coverage and Spray Pattern
- Industry's Only Self-Draining Design – The Aquaduct™
- Separate Supply and Waste Pipes – Meets CEN and Plumbing Requirements
- Ergonomic Hand Activation Eyewash Paddle – Easy to Reach from Any Direction
- Fully-Assembled and Factory-Tested Eyewash or Eye/Face Wash with Hinged Dust Covers
- Yellow Transparent Plastic and Stainless Steel Bowl Covers Available
- Barrier Free Options Are Available
- Universal Identification Sign and Inspection Tag Included
- Certified by DVGW to EN 15154-2 and EN 15154-1
- Certified by IAPMO OCEANA to AS4775 and AS/NZS 4020
- SpinTec showerheads are covered by one or more of the following patents: 8113446; D594,089; D669,555; Reg. Comm. Des. D001079560-0001. Other patents pending.
- Halo is Covered by One or More of the Following Patents: D662,220; D662,219; D685,920. Other Patents Pending.



Specifications

Standard and Barrier-Free Combination Drench Shower/Eyewash or Eye/Face Wash Units save space and fit easily into any work environment. Shower valve operates quickly by a pull rod with a triangular handle. Shower provides a superior washdown with a more even spray pattern. Halo eyewash or eye/face wash, operated by an ergonomic, highly visible push handle, provides effective wash down coverage and spray pattern. Integral strainer reduces debris in the water and also prevents clogging.

This plumbing fixture is not intended to dispense water for human consumption through drinking or for preparation of food or beverages.

Pipe and Fittings

1/4" piping assembly manufactured of one of the following materials:

- Type 304 corrosion resistant stainless steel
- Type 316 corrosion-resistant stainless steel

Ball Valve

1" shower ball valve and 1/2" stay-open eye and eye/face wash valve manufactured of the following materials and supplied with either type 304 or 316 stainless steel pull rod and handle:

- Type 316 stainless steel

SpinTec™ Showerhead

Standard showerhead is 3.1" (78.7mm) diameter highly visible yellow impact-resistant plastic. Optional 10 3/4" (273mm) diameter corrosion-resistant stainless steel shroud. High performance Type 304 or Type 316 corrosion-resistant stainless steel showerhead measures 1 1/2" (38mm) in diameter. SpinTec drench showerhead features integral 22 GPM (83.3 L) flow control (exceeds minimum water flow of 20 GPM (75.7L) at 30 PSI (2.0 bar)), conserving water and helping to accurately size your tepid water system.

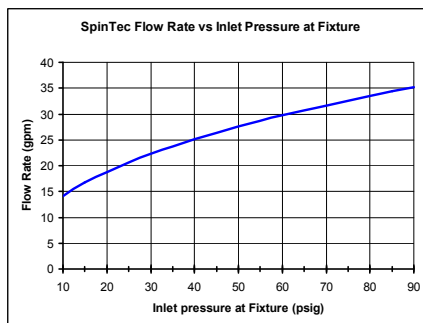

Eyewash

The Halo eyewash system offers a high performance rinsing platform that provides rapid relief to an individual's eyes that have been injured by chemicals or particulate. The eyewash includes an integral 5.1 GPM (19.2 L) flow control, providing water at a safe velocity while maintaining its effectiveness (exceeds minimum water flow of 0.4 GPM (1.5 L) at 30 PSI (2.0 bar)). The eyewash is protected by flip open dust covers that open when the product is activated by Type 304 or Type 316 stainless steel push handle or by a full bowl dust cover that activates the unit when it is opened. Safe, steady water flow under varying water supply conditions from 30–90 PSI (2.0–6.1 bar) is assured by integral flow control in the sprayhead assembly.

Eye/Face Wash

The Halo eye/face wash system offers a high performance rinsing platform that provides rapid relief to an individual's eyes and face that have been injured by chemicals or particulate. This system provides the most complete face wash available in the market. The eye/face wash includes an integral 5.1 GPM (19.2 L) flow control, providing water at a safe velocity while maintaining its effectiveness (exceeds minimum water flow of 3.0 GPM (11.4 L) at 30 PSI (2.0 bar)). The eye/face wash is protected by flip open dust covers that open when the product is activated or by a full bowl dust cover that activates the unit when it is opened. Safe, steady water flow under varying water supply conditions from 30–90 PSI (2.0–6.1 bar) is assured by integral flow control in the sprayhead assembly. Sprayheads are made from an impact resistant ABS plastic or from durable 304/316 stainless steel with electro-polished finish.

Bowl

Bowl is constructed of yellow impact-resistant plastic, Type 304 corrosion-resistant stainless steel or Type 316 corrosion-resistant stainless steel.

Bowl Dust Cover (Optional)

Optional dust cover is constructed of transparent yellow impact-resistant plastic, Type 304 corrosion-resistant stainless steel or Type 316 corrosion-resistant stainless steel.

Foot Activation (Optional)

Foot activation by Type 304 or Type 316 stainless steel pedal.

Tepid Water Options

Navigator S19-2100 EFX25
Emergency Thermostatic Mixing Valve



Keltech® SNA-Series
Tankless Water Heater

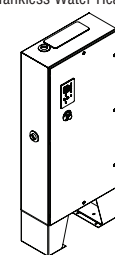

NAVIGATOR

Satisfies ANSI/ISEA Z358.1 tepid water requirements.

For information on all available S19314 models, please see tech data document Bradley_SafetyCombi_S19314Series.



Halo Pre-Configured Models

All models with DIN-DVGW, AS4775 & AS/NZS 4020 Certification include stainless steel pipe material with BSPP threading.

| Halo Model Number | Description | IAPMO Oceana certified to AS4775 & AS4020 | DIN-DVGW certified to DIN EN 15154-1 & DIN EN 15154-2 |
|---|---|---|---|
| Eyewashes | | | |
| <input type="checkbox"/> S19314EWZS | Halo Eyewash, plastic showerhead & bowl | X | X |
| <input type="checkbox"/> S19314SBZS | Halo Eyewash, plastic showerhead, stainless steel bowl | X | X |
| <input type="checkbox"/> S19314LLZS | Halo Eyewash, plastic showerhead, stainless steel bowl, hand/foot activated | X | X |
| <input type="checkbox"/> S19314FZS | Halo Eyewash, plastic showerhead w/ stainless steel shroud & bowl | X | X |
| <input type="checkbox"/> S19314UUZS | Halo Eyewash, plastic showerhead w/ stainless steel shroud & bowl, hand/foot operated eyewash | X | X |
| Eyewashes with Dust Cover | | | |
| <input type="checkbox"/> S19314PDCZS | Halo Eyewash, plastic showerhead & bowl w/ hinged dust cover | X | X |
| <input type="checkbox"/> S19314DCZS | Halo Eyewash, plastic showerhead, stainless steel bowl & hinged dust cover | X | X |
| Eye-Face Washes | | | |
| <input type="checkbox"/> S19314FWZS | Halo Eye/face wash, plastic showerhead & bowl | X | X |
| <input type="checkbox"/> S19314SBFWZS | Halo Eye/face wash, plastic showerhead, stainless steel bowl | X | X |
| <input type="checkbox"/> S19314ACZS | Halo Eye/face wash, plastic showerhead, stainless steel bowl, hand/foot operated eyewash | X | X |
| <input type="checkbox"/> S19314TTZS | Halo Eye/face wash, plastic showerhead w/ stainless steel shroud & bowl | X | X |
| <input type="checkbox"/> S19314SPRZS | Halo Eye/face wash, stainless steel showerhead & bowl, hand/foot operated eyewash | X | |
| <input type="checkbox"/> S19314BFPBZS | Halo Eye/face wash, barrier-free, plastic showerhead & bowl | X | X |
| <input type="checkbox"/> S19314BFZS | Halo Eye/face wash, barrier-free, plastic showerhead, stainless steel bowl | X | X |
| Eye-Face Washes with Dust Covers | | | |
| <input type="checkbox"/> S19314PDCFWSZ | Halo Eye/face wash, plastic showerhead & bowl w/ hinged dust cover | X | X |
| <input type="checkbox"/> S19314DCFWSZ | Halo Eye/face wash, plastic showerhead, stainless steel bowl & hinged dust cover | X | X |
| <input type="checkbox"/> S19314DCBFZS | Halo Eye/face wash, barrier-free, plastic showerhead, stainless steel bowl w/ hinged dust cover | X | X |
| Eye-Face Washes without Eyewash Bowl | | | |
| <input type="checkbox"/> S19314GGZS | Halo Eye/face wash, plastic showerhead, no bowl | X | X |
| All Stainless Steel Eye-Face Wash | | | |
| <input type="checkbox"/> S19314BFSSZ | Halo stainless steel eye/face wash & showerhead, barrier free | X | |
| <input type="checkbox"/> S19314FSSZ | Halo stainless steel eye/face wash & showerhead | X | |
| <input type="checkbox"/> S19314SCZ | Halo stainless steel eye/face wash, bowl, cover & showerhead | X | |
| <input type="checkbox"/> S19314SSZ | Halo stainless steel eye/face wash and showerhead with hand/foot activation | X | |
| <input type="checkbox"/> S19314SS16Z | Halo 316 stainless steel eye/face wash and showerhead with hand/foot activation | X | |



S19314 Series

European and Australian Drench Shower and Halo Eyewash or Eye/Face Wash

S19314 shown with Plastic Bowl and Showerhead

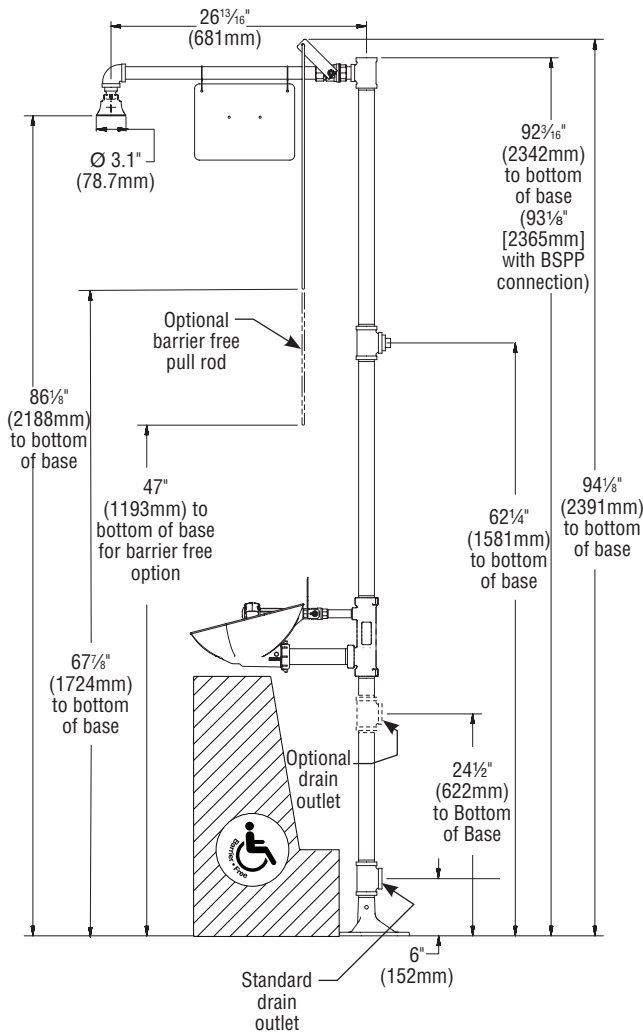

Plastic Showerhead with Stainless Steel Shroud

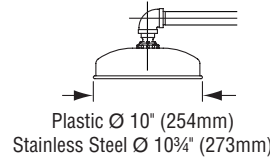

Type 304 and 316 Stainless Steel Showerheads

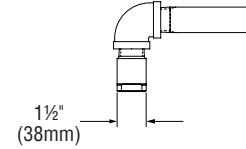

Eyewash Bowl

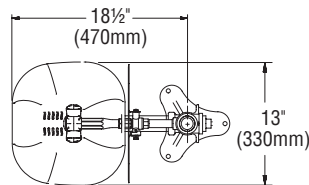

Dust Cover

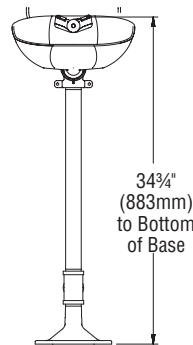
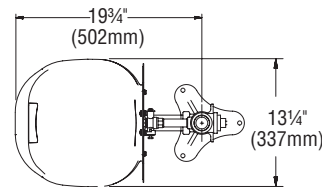

Foot Pedal Activation

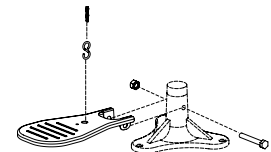

All dimensions assume standard thread engagement. Variations in manufacturing allow for $\pm \frac{1}{8}"$ (3mm) per threaded joint. To find the tolerance of a dimension, add the number of thread joints across the length of the dimension and multiply it by $\frac{1}{8}"$ (3mm).