

- Complies with American National Standard Z358.1
- Laboratory Spray Valve
- Easily Attaches to Any Bradley Drench Hose or Eyewash
- Highly Visible Yellow-Colored Hose
- Full, One-Year Warranty
- Classified by Underwriters Laboratory Inc. to ANSI Z358.1



## Specifications

Kit includes all necessary fittings and hanger for attaching hose to eyewashes or drench showers (sold separately). S19-430EH attaches to eyewashes and S19-430SH attaches to drench showers. Perforated sprayhead provides soft spray for cleansing eyes and face. Handle stays open once valve is squeezed. Hand-held hose sprayhead contains an antimicrobial agent to protect the sprayhead.

- Plumbing fixtures are not intended to dispense water for human consumption through drinking or for preparation of food or beverages.*
- Drench hoses must provide a controlled flushing fluid flow that is both tepid and non-injurious to the user per ANSI Z358.1. Refer to ANSI Z358.1 for complete regulatory information regarding the performance, installation, maintenance, and training requirements for drench hoses.*
- Installer to supply backflow prevention as required by UPC, IPC and/or local plumbing codes. Contact Bradley or visit [bradleycorp.com](http://bradleycorp.com) for available options.*

## Standard Equipment

### Sprayhead

Perforated sprayhead is ABS plastic and provides soft spray for cleansing eyes and face. Includes protective sprayhead cover. Integral flow control assures safe, steady flow under varying water supply conditions.

### Valve

Chrome-plated brass with extended handle stays open once handle is squeezed.

### Drench Hose

8' (2438mm) yellow reinforced thermoplastic hose has 3/8" NPT male thread. Burst strength is 450 PSI.

### Attachment Kit

Kit includes necessary fittings and hanger for attaching hose to eyewashes or drench showers. Model S19-430EH includes a 1/2" NPT supply.

Model S19-430EH

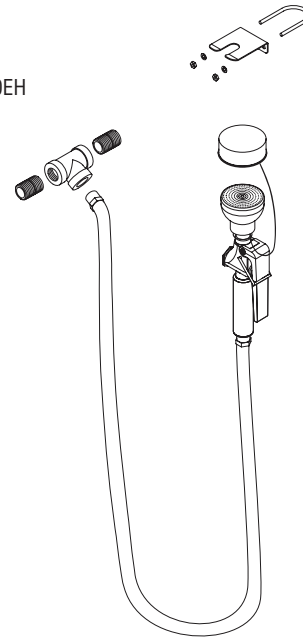

Model S19-430SH

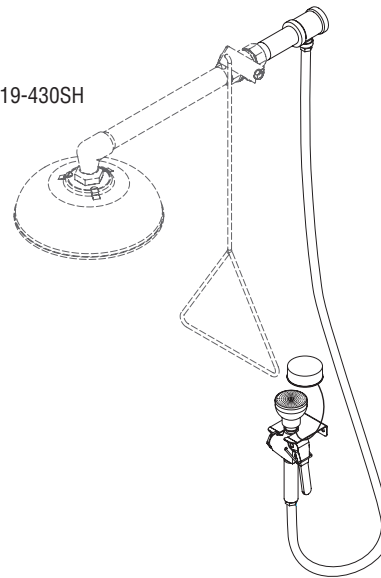

Model	Description
<input type="checkbox"/> S19-430EH	Hand Held Hose Spray Attachment Kit for <b>Eyewashes</b> (sold separately)
<input type="checkbox"/> S19-430SH	Hand Held Hose Spray Attachment Kit for <b>Drench Showers</b> (sold separately)
<input type="checkbox"/> S27-303	Series 7 Dual-Check Backflow Preventer
<input type="checkbox"/> S45-2309	Series 9 Dual-Check Vacuum Breaker
<input type="checkbox"/> S45-2310	Series 9D Dual-Check Backflow Preventer