



## KB200 Replacement Bungee Cord Instructions

P/N 481-KIT

### Items Included: Bungee Cord (1pc)

1. Unlock and open the liner dispenser lid to expose the liner dispenser cavity.
2. If the old bungee cord is still in place remove it along with any liners in the cavity.
3. On the left and right sides of the liner dispenser cavity there are keyhole slots. Take the new bungee cord and insert one of the metal tabs at the ends of the bungee cord into one of the slots. Twist the bungee cord so that the metal tab is horizontal across the inside of the slot and pull it up to the top of the slot.
4. Repeat the process of the opposite side ensuring that you keep the tension on the first side while you install the second side.
5. Once both sides are secure, pinch the middle of the bungee cord together to create a loop. Pull the loop towards the top of the liner dispenser and insert it over the recessed tab between the liner cavities.
6. Fill the liner cavities with new liners, close and lock the liner dispenser lid. Close the unit.

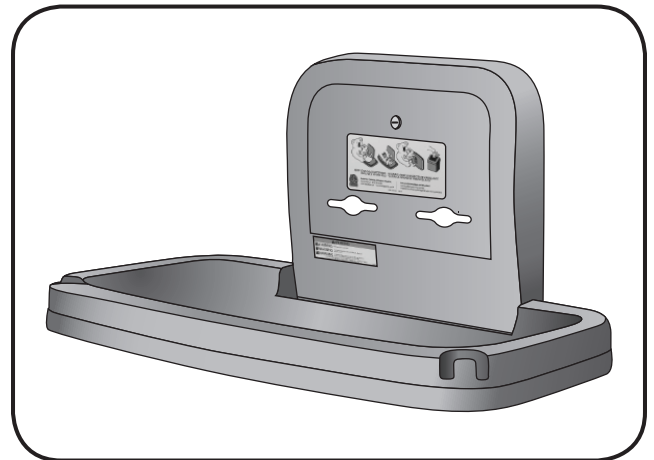
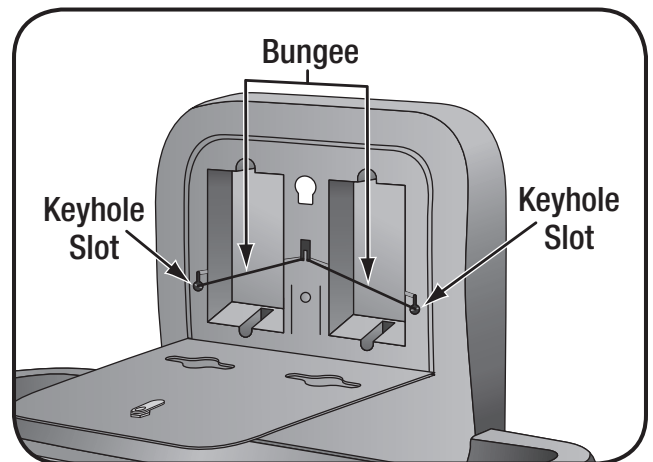
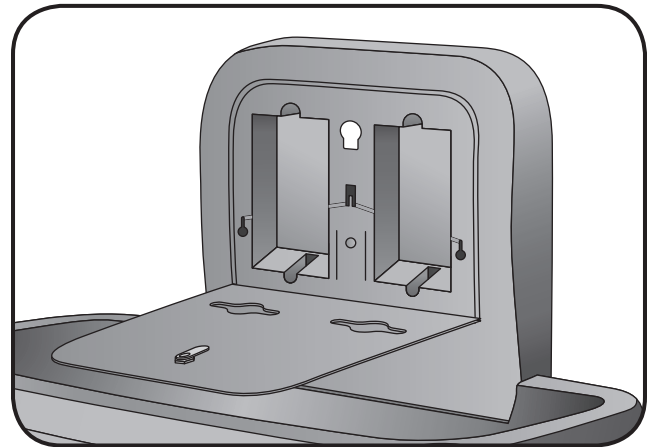

**Koala Kare Products** A Division of Bobrick  
6982 South Quentin St., Centennial, CO 80112-3945

**Main** 303.539.8300 **Toll Free** 888.733.3456  
**Fax** 303.539.8399 **Koalabear.com**

P/N 359 - March 2017