



T&S BRASS AND BRONZE WORKS, INC.
 2 SADDLEBACK COVE / P.O. BOX 1088 / TRAVELERS REST, SC 29690
 PHONE 800-476-4103 FAX 864-834-3518



Model No.

B-5K

Item No.:

Job Name:

Architect/Engineer Approval:

Notes:

015295-40 LH
 SPINDLE, SCREW,
 WASHER
 ASSEMBLY. (1)
 SUPPLIED

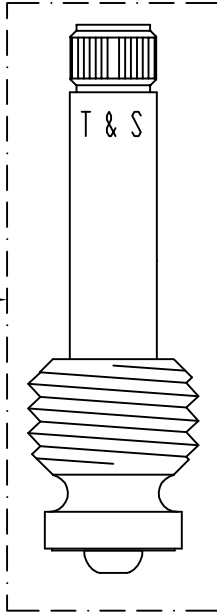

015294-40 RH
 SPINDLE, SCREW,
 WASHER
 ASSEMBLY. (1)
 SUPPLIED

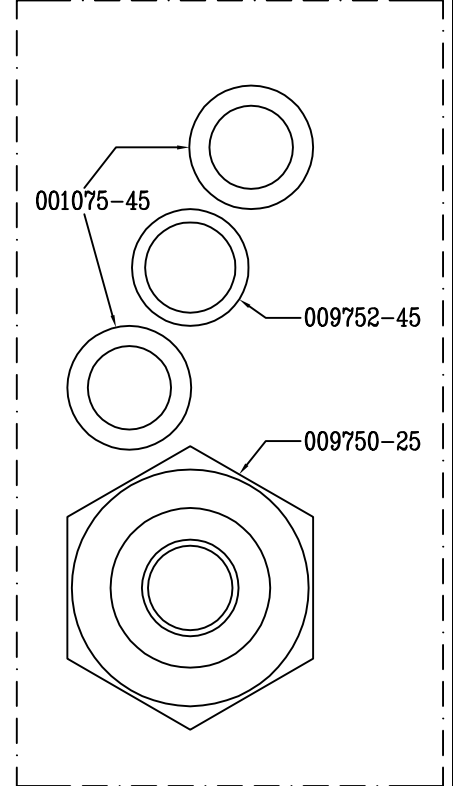
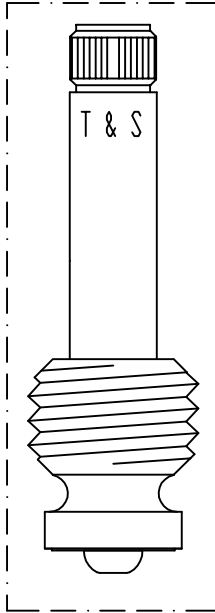

000761-20
 REMOVABLE SEAT
 (6 SUPPLIED)

010197-25
 BIG-FLO BONNET ASSEMBLY
 (INCLUDES O-RINGS & WASHER)
 (12 SUPPLIED)

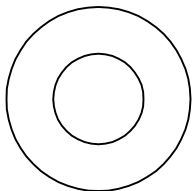

002726-45
 WASHER
 (12 SUPPLIED)

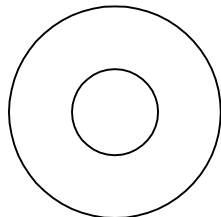

009635-45
 WASHER
 (12 SUPPLIED)

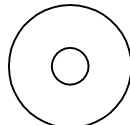

009649-45
 WASHER
 (22 SUPPLIED)

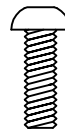

000933-45
 SCREW
 (4 SUPPLIED)

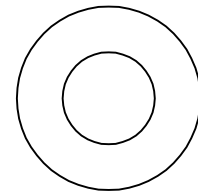

000976-45
 WASHER
 (12 SUPPLIED)

Instruction included in parts kit.

Product Description:

JOB PARTS KIT

Drawn:

WJS

Approved

MVW

Checked

JKD

Scale:

1:1

Date:

1/25/05