

PIEXO AIR FRESHENER

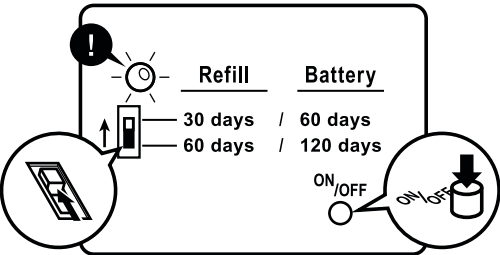

Standard Settings (4) AA

Replace refill in 30 days, batteries in 60



Standard Settings (4) C

Replace refill in 60 days, batteries in 120

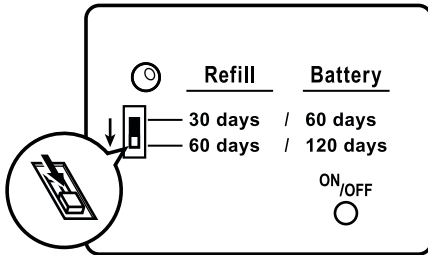

Standard Settings (4) C

Replace refill in 60 days, batteries in 120

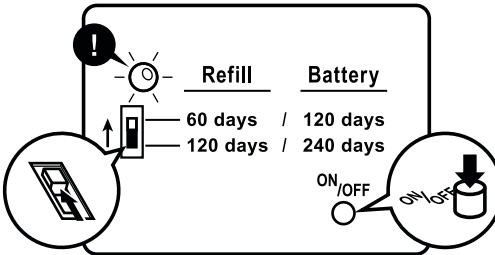

Standard Settings (4) C

Replace refill in 120 days, batteries in 240

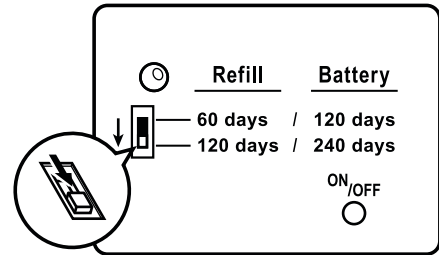

Program Settings

1. Set Day & Clock

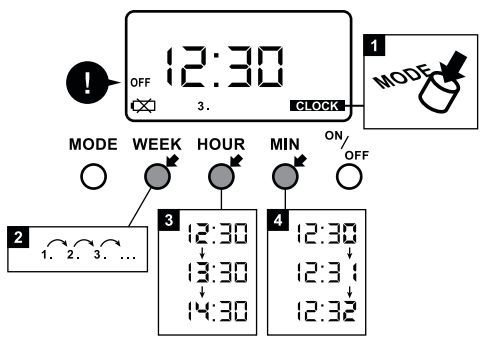

2. Spray Start Time

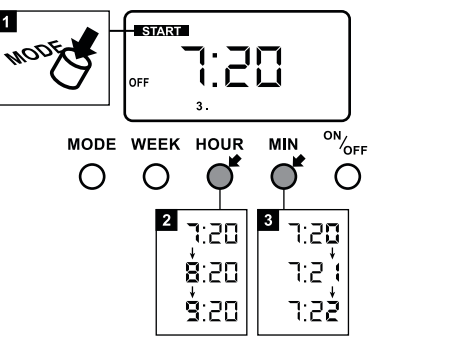

3. Spray End Time

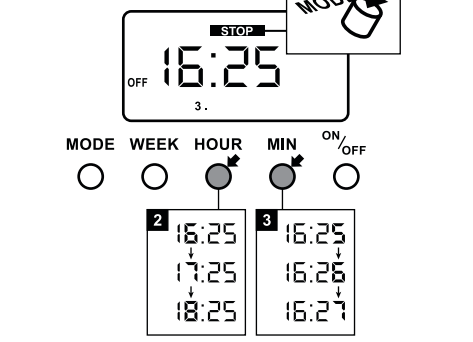

4. Spray Interval

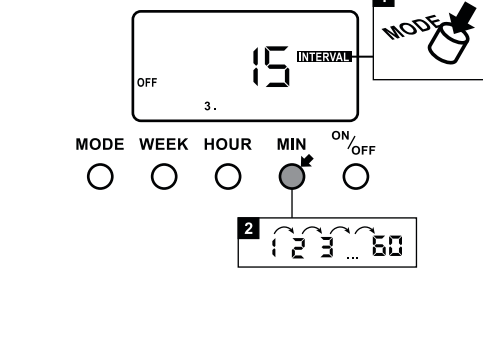

5. Days Per Week

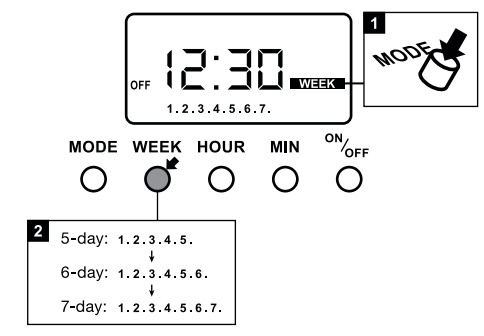

6. Program On

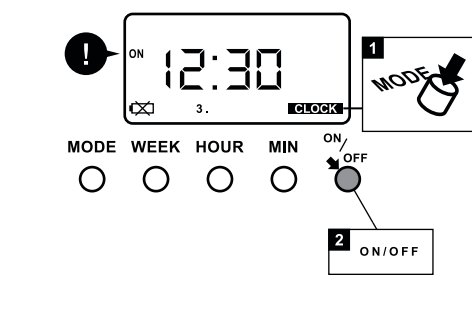

Check Spray History

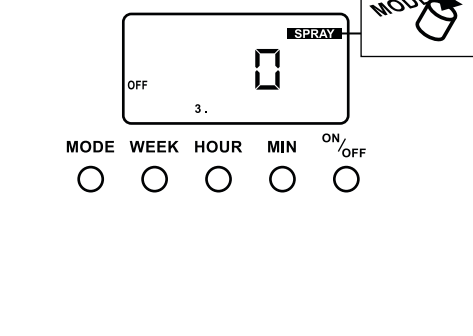

PIEXO AIR FRESHENER

Installation Instructions

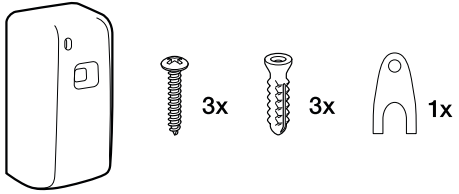

Recommended Installation Height

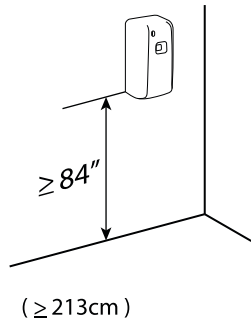

Open Dispenser

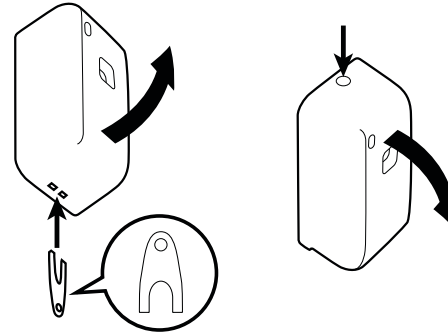

Light Indicator

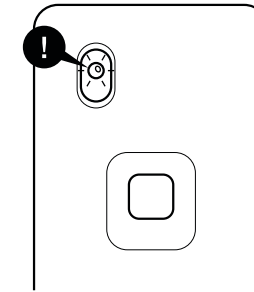

Operating: blinking green

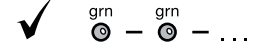

Bottle Empty: blinking red

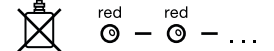

Battery Low: no light

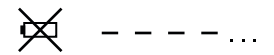

Installation with Screws

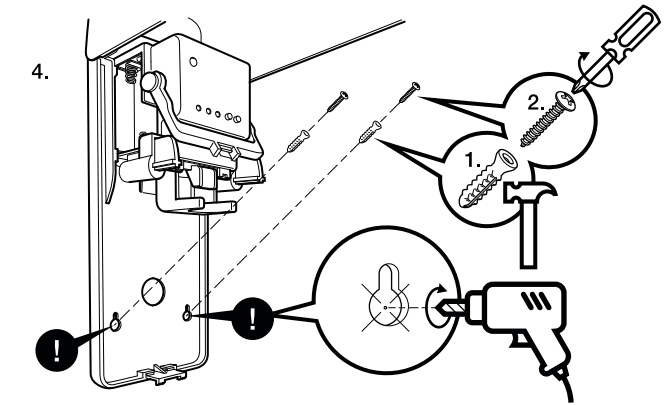
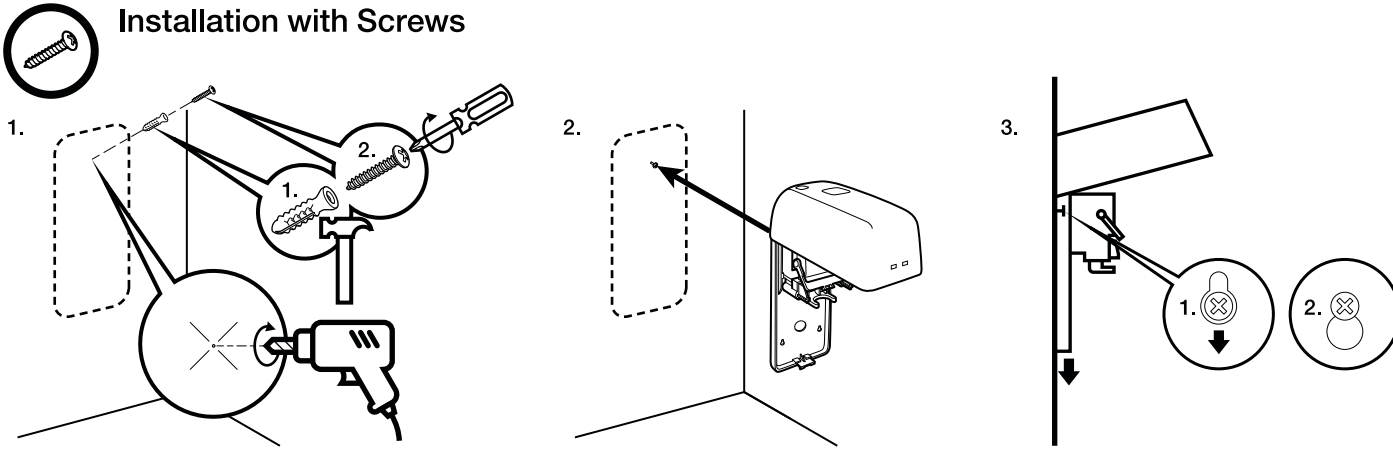

Install w/ Adhesive Backing (no screws)

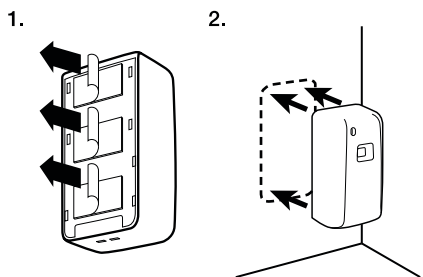

Install Cartridge

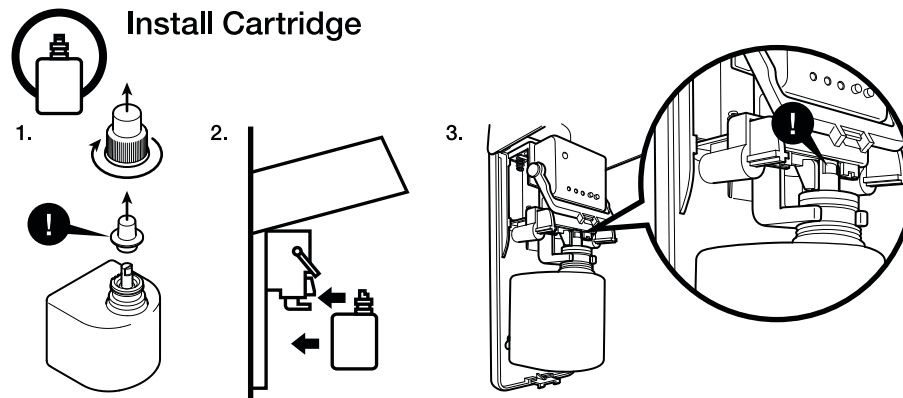

Install Batteries

