



T&S BRASS AND BRONZE WORKS, INC.

2 Saddleback Cove / P.O. Box 1088
Travelers Rest, SC 29690

Model No.

BL-5700-01

Item No.

Travelers Rest, SC: 800-476-4103 • Simi Valley, CA: 800-423-0150 • Fax: 864-834-3518 • www.tsbrass.com

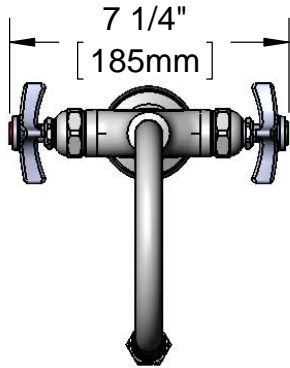

ADA Compliant

This Space for Architect/Engineer Approval

Job Name _____ Date _____

Model Specified _____ Quantity _____

Customer/Wholesaler _____

Contractor _____

Architect/Engineer _____

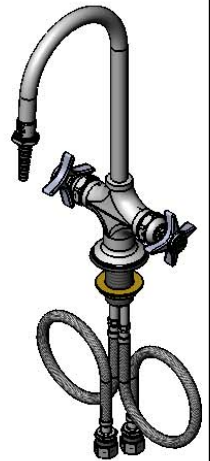

Rigid Gooseneck w/
B-0198
Serrated Tip & Washer

13 11/16"
[347mm]

6 5/8"
[169mm]

5 5/8"
[143mm]

Mounting
Surface

1 3/8"
[34mm]
Maximum
Thickness

Eterna Cartridges
& 4-Arm Handles
w/ Color Coded
Indexes

2 3/8"
[60mm]

Base Gasket

18" Flexible
Stainless Steel
Supply Hoses

Compression Fittings
for 5/8" O.D. Copper Tubing
(Remove Compression Nut
for 1/2" NPSM Male)

Rough-In Requirement:
Ø 1 1/4" [32mm] Mounting Hole

Product Specifications:

Single Hole Deck Mount Mixing Faucet, Eterna Cartridges, 4-Arm Handles, Rigid Gooseneck w/ Serrated Tip Outlet & 18" Flexible Stainless Steel Supply Hoses w/ 1/2" NPSM Male Inlets

Product Compliance:

ASME A112.18.1 / CSA B125.1
NSF 61 Exempt (Non-Potable)
ANSI A117.1 (ADA)



T&S BRASS AND BRONZE WORKS, INC.
 2 Saddleback Cove / P.O. Box 1088
 Travelers Rest, SC 29690

Model No.
BL-5700-01

Item No.

Travelers Rest, SC: 800-476-4103 • Simi Valley, CA: 800-423-0150 • Fax: 864-834-3518 • www.tsbrass.com

ITEM NO.	SALES NO.	DESCRIPTION
1	B-0198	Serrated Tip w/ Washer
2	001051-45	Washer
3	000398-40	Rigid Gooseneck
4	005960-40	Eterna Cartridge - RTC
5	001191-45	Green Index - CW
6	002290-45	Lock Washer
7	000965-45	Lock Nut
8	012534-45	18" Flexible Supply Hose (2)
9	145L	Black Plastic Base Gasket
10	000059-40	4-Arm Lab Handle
11	000925-45	Lab Handle Screw
12	001194-45	Red Index - HW

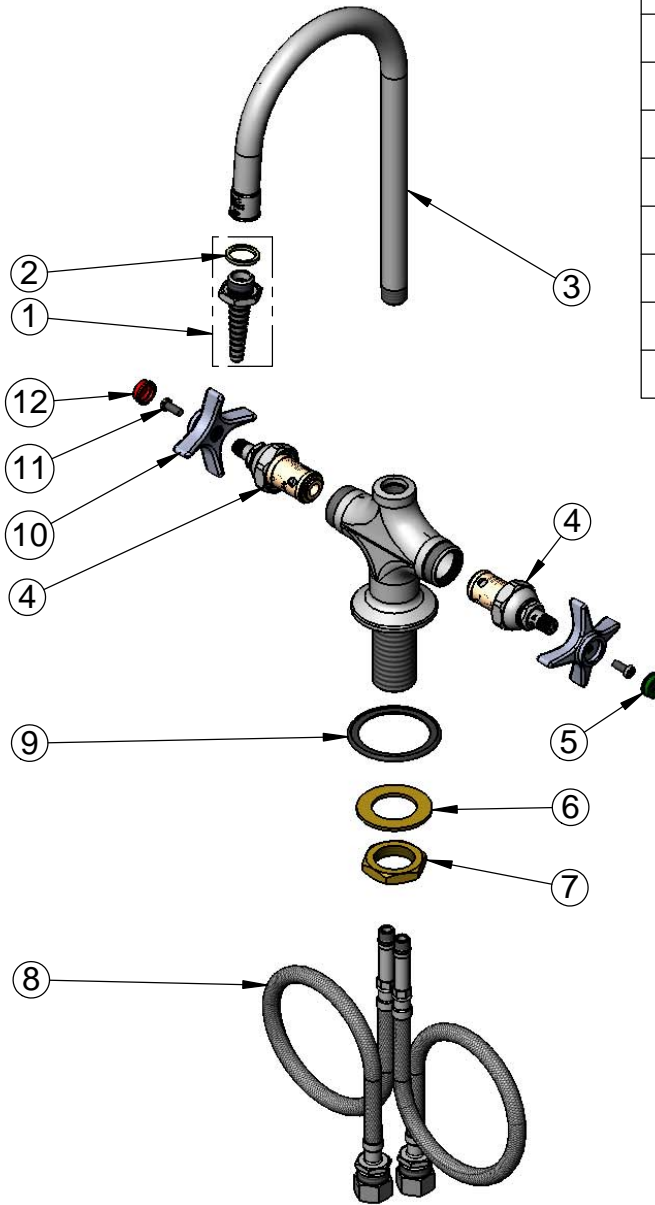

Product Specifications:

Single Hole Deck Mount Mixing Faucet, Eterna Cartridges, 4-Arm Handles, Rigid Gooseneck w/ Serrated Tip Outlet & 18" Flexible Stainless Steel Supply Hoses w/ 1/2" NPSM Male Inlets

Product Compliance:

ASME A112.18.1 / CSA B125.1
 NSF 61 Exempt (Non-Potable)
 ANSI A117.1 (ADA)



T&S BRASS AND BRONZE WORKS, INC.

2 SADDLEBACK COVE / P.O. BOX 1088 / TRAVELERS REST, SC 29690

PHONE 800-476-4103 - FAX 864- 834-3518

Model No.

BL-5700-02

RELIABILITY
BUILT IN

Job Name:

Architect/Engineer Approval:

Notes:



ADA COMPLIANT

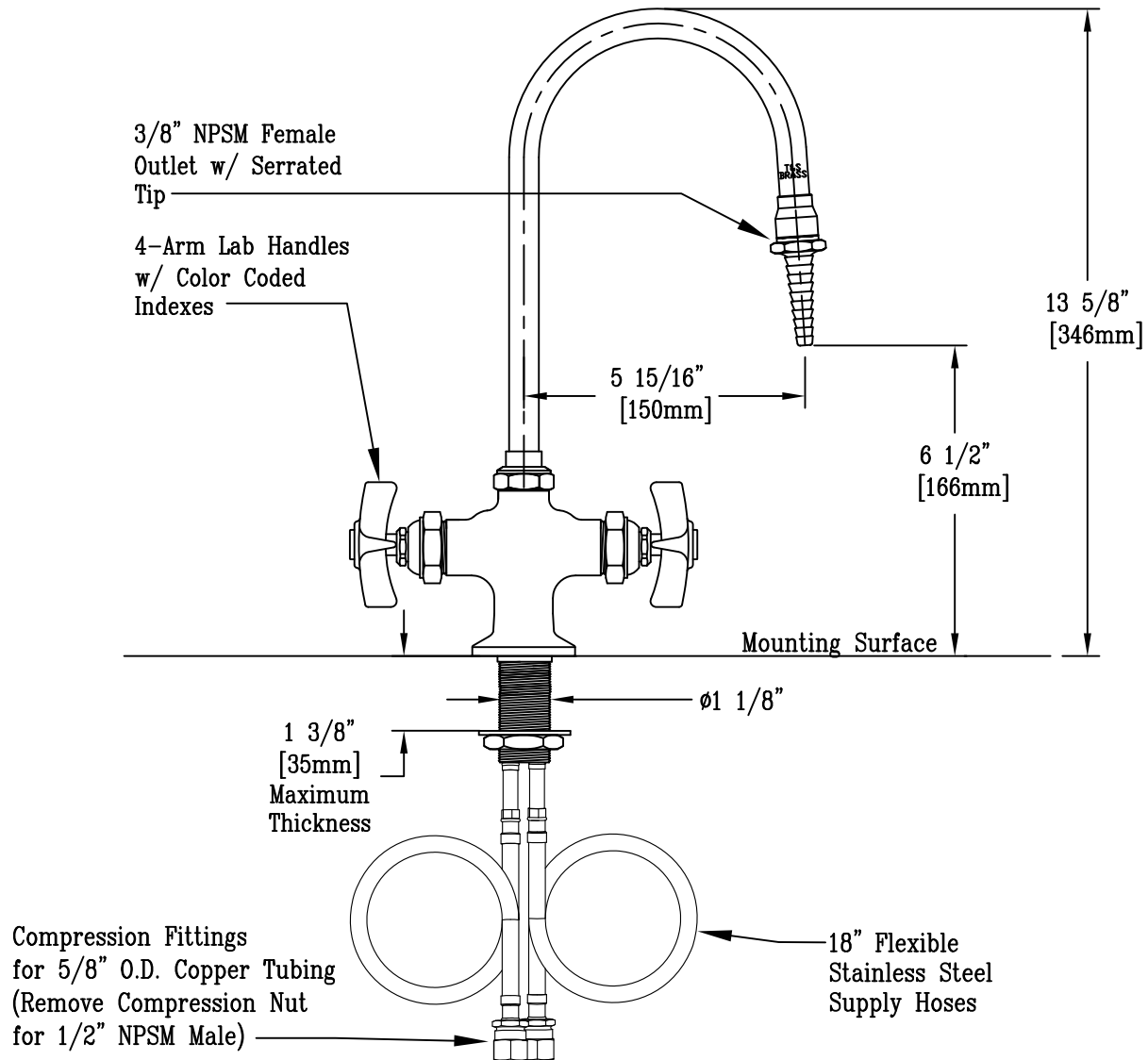

Rough-In Requirement:

Ø1 1/2" [38mm] Mounting Hole

Product Description:

Single Hole Deck Mount Mixing Faucet, Eterna Cartridges, Swivel Gooseneck, Serrated Tip Outlet, 4-Arm Lab Handles, 18" Flexible Stainless Steel Supply Hoses w/ 1/2" NPT male Inlets

Drawn:

JRM

Checked

DHL

Scale:

1 : 4

Approved

JHB

Date:

01/09/15

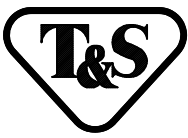

T&S BRASS AND BRONZE WORKS, INC.

2 SADDLEBACK COVE / P.O. BOX 1088 / TRAVELERS REST, SC 29690

PHONE 800-476-4103 - FAX 864- 834-3518

Model No.

BL-5700-03

RELIABILITY
BUILT IN

Job Name:

Architect/Engineer Approval:

Notes:



ADA COMPLIANT

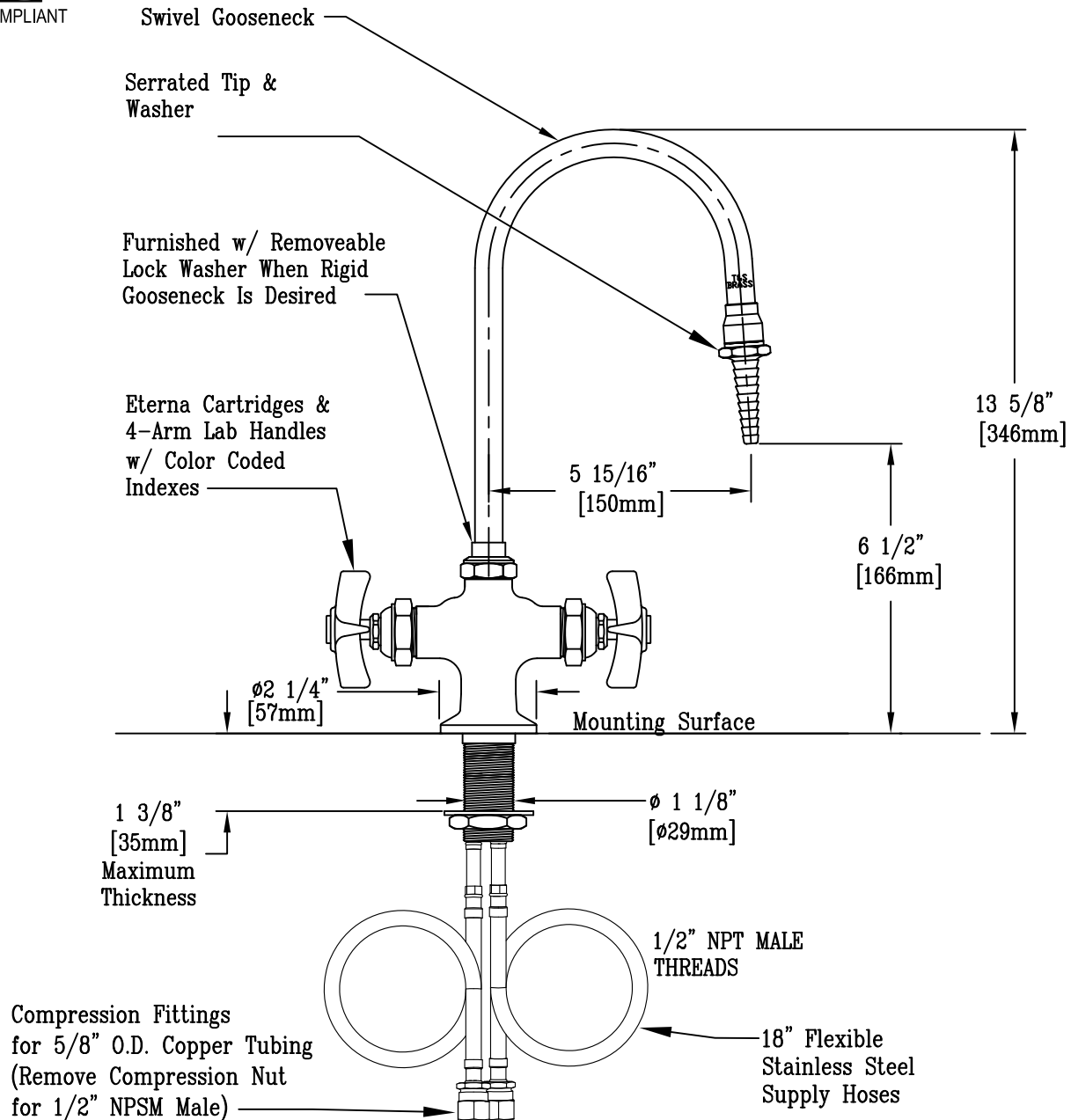

Rough-In Requirement:

Ø1 1/2" [38mm] Mounting Hole

Product Description:

Single Hole Mixing Faucet, Eterna Cartridges, 4-Arm Lab Handles, Serrated Tip Outlet, 18" Flexible Stainless Steel Supply Hoses w/ 1/2" NPT Male Inlets

Drawn:

JRM

Checked

DHL

Scale:

1 : 4

Approved

JHB

Date:

01/09/15

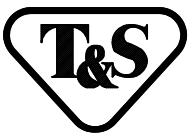

T&S BRASS AND BRONZE WORKS, INC.
 2 SADDLEBACK COVE / P.O. BOX 1088 / TRAVELERS REST, SC 29690
 PHONE 800-476-4103 - FAX 864- 834-3518

Model No.

BL-5700-04

**RELIABILITY
 BUILT IN**

Job Name:

Architect/Engineer Approval:

Notes:



ADA COMPLIANT

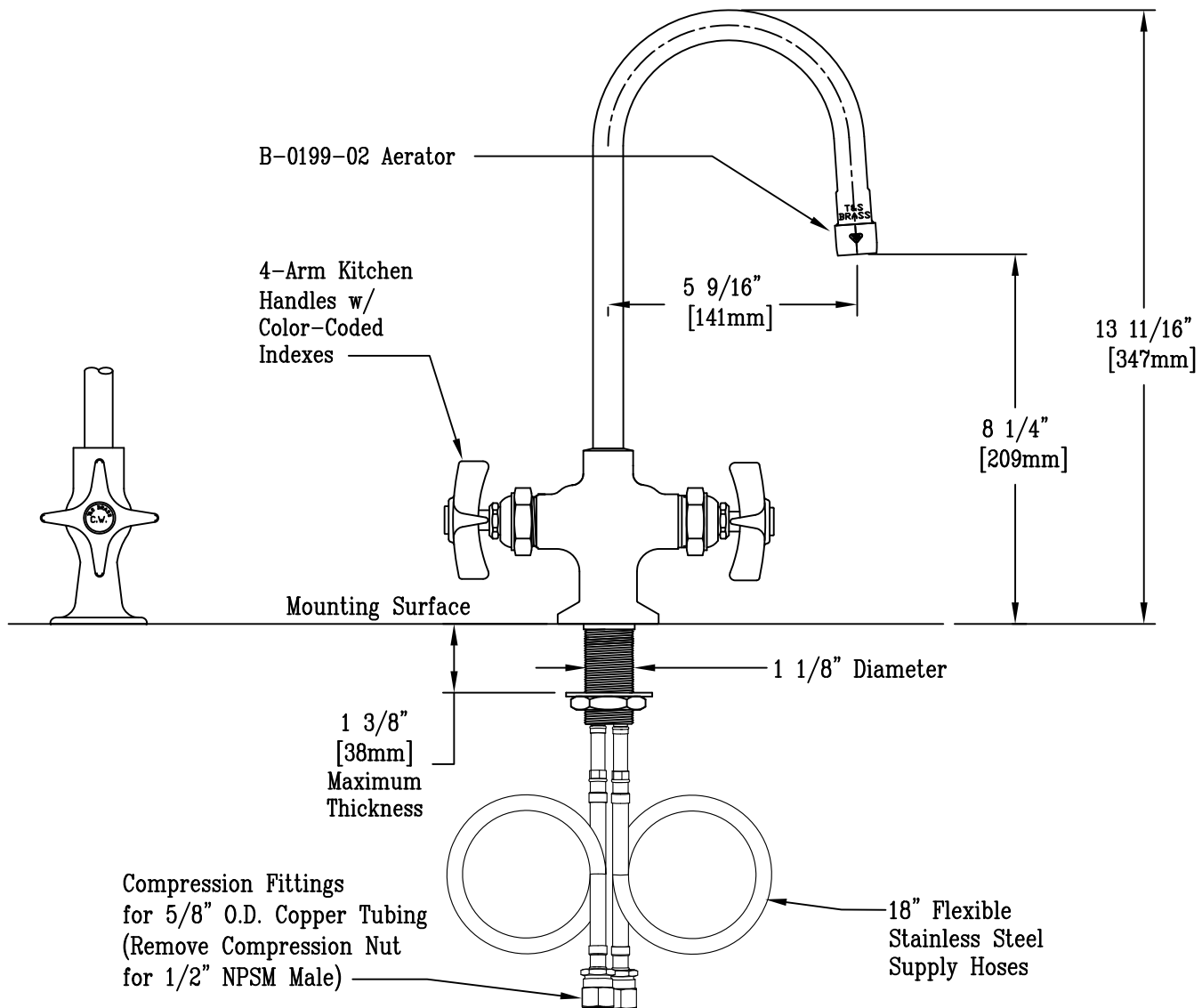

Product Description:
 Single Hole Deck Mount Mixing faucet, Rigid Gooseneck, Aerator, 4-Arm Lab Handles & 18" Flexible Stainless Steel Supply Hoses w/ 1/2" NPT Male Inlets

Drawn:

JRM

Checked

DHL

Scale:

1 : 4

Approved

JHB

Date:

01/09/15