

“Designed Simplicity”



*INTRODUCING*  
*Watts*  
*GoldenEagle™*  
*Reduced*  
*Pressure Zone*  
*Assemblies*  
*Series 919*  
*1/4" - 2"*



WATTS  
GOLDEN EAGLE™



Watts Regulator Company's new GoldenEagle™, Series 919 Reduced Pressure Zone Assemblies have been developed to provide both trouble free operation in all types of water conditions and ease of service. Series 919 may be used in those cross-connections that have been identified as health hazard applications.

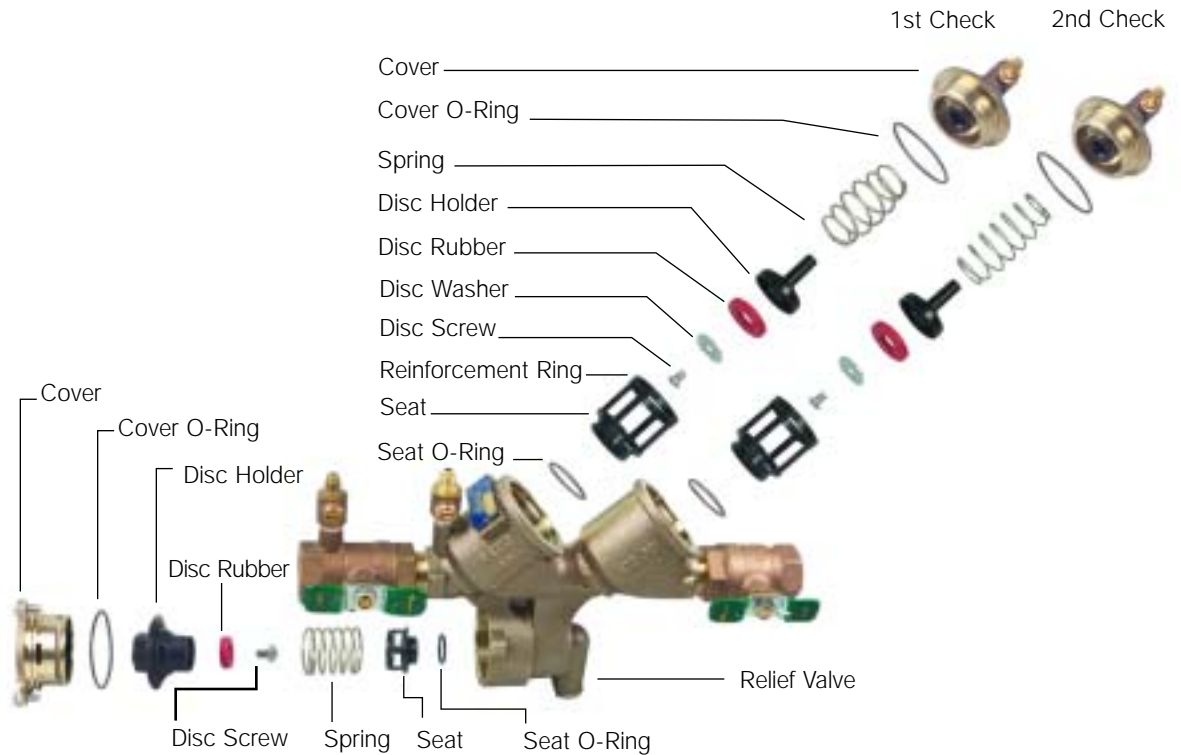

### FEATURES:

- Separate access covers for the check valves and relief valve for ease of maintenance
- Top entry — all check internals easily accessible
- All rubber elastomers of chloramine resistant material
- Check valve poppet assemblies are fully guided by innovative plastic seat guide
- Replaceable push-in check valve and relief valve seat eliminates threads from the water way
- EZ twist relief valve cover — quarter turn locking joint captures the spring load to facilitate repair
- Innovative check valve plastic cover bushing provides trouble free guiding of the check valve poppet
- Bottom mounted relief valve provides reduced installation clearances
- Compact, space saving design
- No special tools required for servicing
- Top mounted test cocks for ease in testing and reduced installation clearances

For additional information, request literature ES-919.



USA: 815 Chestnut St., No. Andover, MA 01845-6098; [www.wattsreg.com](http://www.wattsreg.com)  
 Canada: 5435 North Service Rd., Burlington, ONT L7L 5H7; [www.wattscanada.ca.com](http://www.wattscanada.ca.com)