

For Residential and Commercial Applications

Job Name _____
 Job Location _____
 Engineer _____
 Approval _____

Contractor _____
 Approval _____
 Contractor's P.O. No. _____
 Representative _____

LEAD FREE*
Series LF3008
Dielectric Unions

Sizes: 1/2", 3/4" and 1" (15, 20 and 25mm)

Series LF3008 dielectric unions feature a female brass pipe thread to female solder connection. These unions are designed to be installed between pipe made from dissimilar metals to prevent accelerated corrosion and deterioration in the piping system due to galvanic and stray current. Designed and manufactured to the highest quality standards. Gasket rated to 210°F (99°) at 250psi (17.2 bar). The LF3008 features Lead Free* construction to comply with Lead Free* installation requirements.

Features

- Female brass pipe thread to female solder connection
- Designed and manufactured to the highest quality standards
- Individually factory certified to withstand a minimum of 600 volts on a dry line with no flashover
- Rated to 180°F (82°C) at 250psi (17.2 bar)

Specifications

The dielectric union shall be constructed using Lead Free* materials. Lead Free* dielectric unions shall comply with state codes and standards, where applicable, requiring reduced lead content. The dielectric union shall be a Watts Series LF3008.

Materials

Steel Parts	ASTM A108
Brass Parts	ASTM B371
Zinc Plating	ASTM B633-85
Standard Gasket A	Buna-N
Optional Gasket B	EPDM

Options

GB - Optional EPDM gasket for use in steam or hot water applications up to 300°F (149°C) at 50psi (3.4 bar).



LF3008

Standards

Meet federal specifications for tensile strength and thread end connections

Pressure – Temperature

Maximum Pressure: 250psi (17.2 bar)
 Maximum Temperature: 180°F (82°C)

Dimensions – Weights

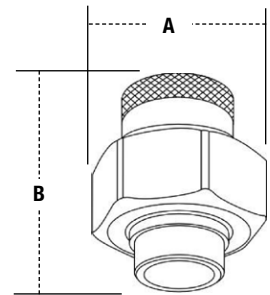

SIZE (DN)		DIMENSIONS				WEIGHT	
		A		B			
in.	mm	in.	mm	in.	mm	oz.	gm.
1/2	15	1 1/2	38	1 7/8	48	6.7	190
3/4	20	1 5/8	41	2 1/8	54	10.7	303
1	25	1 7/8	48	2 1/2	64	14.7	417

*The wetted surface of this product contacted by consumable water contains less than one quarter of one percent (0.25%) of lead by weight.

Watts product specifications in U.S. customary units and metric are approximate and are provided for reference only. For precise measurements, please contact Watts Technical Service. Watts reserves the right to change or modify product design, construction, specifications, or materials without prior notice and without incurring any obligation to make such changes and modifications on Watts products previously or subsequently sold.



USA: 815 Chestnut St., No. Andover, MA 01845-6098; www.watts.com
Canada: 5435 North Service Rd., Burlington, ONT. L7L 5H7; www.wattscanada.ca

