

**OPTIMA ETF-600 and ETF-610 Faucets**

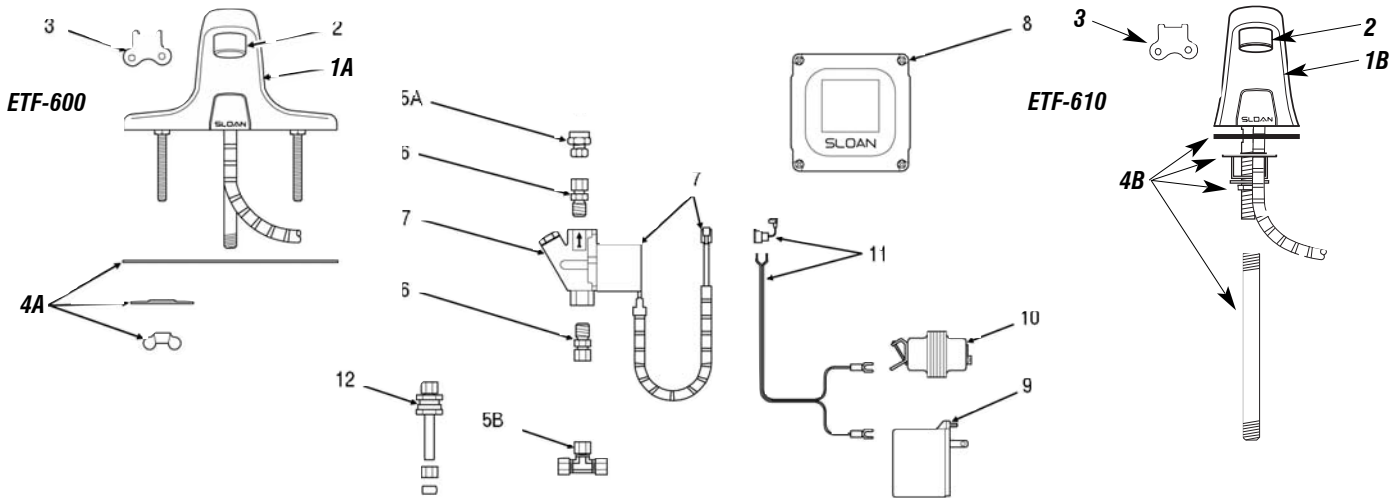

**Parts List—ETF-600 and ETF-610 Faucets**

| Item Number | Code Number | Part Number | Description   |
|-------------|-------------|-------------|---|
| 1A          | 0365086     | ETF-543-A   | Faucet and Sensor Assembly (ETF-600)  |
| 1B          | 0365117     | ETF-570-A   | Pedestal Faucet and Sensor Assembly (ETF-610)   |
| —           | 0365070     | ETF-542-A   | Sensor Module Only (for ETF-600 and ETF-610 faucets) includes 18" (153 mm) armored Cable, Shroud, and Housing for Sensor Window   |
| 2           | 3365092     | ETF-1023-A  | 0.5 gpm (1.9 Lpm) Spray Head with Key (male thread)   |
|             | 3365093     | ETF-1024-A  | 2.2 gpm (8.3 Lpm) Aerator Spray Head with Key (male thread)   |
|             | 0305607     | F-175-L     | 2.2 gpm (8.3 Lpm) Laminar Flow Spray Head (male thread)   |
| 3           | 0305927     | ETF-435     | Replacement Key Only for ETF-1023-A Spray Head and ETF-1024-A Aerator Spray Head (NOT required for F-175-L Laminar Flow Spray Head)   |
| 4A          | 3365088     | ETF-546-A   | Faucet Mounting Kit for ETF-600 includes Base Gasket, two (2) Slotted Mounting Washers, two (2) Wing Nuts, and ETF-547 Compression Fitting Connector                            |
| 4B          | 0315085     | EBF-123-A   | Faucet Mounting Kit for ETF-610 includes Spacer, Base Gasket, 1/4" NPSM Hex Nut, Washer, 9/16" Lockwasher, ETF-547 Compression Fitting Connector, and 3/8" RB Water Supply Tube |
| 5A          | 0365058     | ETF-547     | 1/8" NPT Pipe to 3/8" Tube Compression Fitting Connector (female)   |
| 5B          | 0305728     | ETF-259     | 3/8" Tee Compression Fitting  |
| 6           | 3365676     | ETF-437-A   | Single Solenoid Supply Kit includes Supply Tube, two (2) ETF-61 Compression Fittings, Compression Nut, and Ferrule  |
| 7           | 0305849     | ETF-370-A   | 24 VAC Solenoid Valve Assembly includes 18" (153 mm) armored Cable and two (2) Terminal Housings  |
| 8           | 3365000     | ETF-450-A   | Control Module Assembly includes splashproof Junction Box and Junction Box Mounting Kit   |
| 9           | 0365534     | ETF-233     | 120V/35VA Plug-In Transformer   |
| 10          | 0345370     | EL-248-40   | 24V/40VA Box Mount Transformer  |
| 11          | 0365001     | ETF-458-A   | Input Power Cable (Transformer to Control Module) includes Strain Relief and two (2) Terminal Crimp Connectors  |
| 12          | 3365001     | ETF-470-A   | Back Check  |
| —           | 3305577     | ETF-1009-A  | Solenoid Valve Repair Kit includes Replacement Filter   |

**FAUCET CABLE EXTENSION CORDS**

|   |         |              |  |
|---|---------|--------------|--|
| — | 0365042 | ETF-1005-26  | Faucet to Control Module Extension Cord; 26 inch (0.7 meter) Length    |
| — | 0365861 | ETF-1005-36  | Faucet to Control Module Extension Cord; 36 inch (0.9 meter) Length    |
| — | 0305862 | ETF-1005-72  | Faucet to Control Module Extension Cord; 72 inch (1.8 meter) Length    |
| — | 0305863 | ETF-1005-108 | Faucet to Control Module Extension Cord; 108 inch (2.7 meter) Length   |
| — | 0365838 | ETF-1003-36  | Solenoid to Control Module Extension Cord; 36 inch (0.9 meter) Length  |
| — | 0365053 | ETF-1003-48  | Solenoid to Control Module Extension Cord; 48 inch (1.2 meter) Length  |
| — | 0365839 | ETF-1003-72  | Solenoid to Control Module Extension Cord; 72 inch (1.8 meter) Length  |
| — | 0365840 | ETF-1003-108 | Solenoid to Control Module Extension Cord; 108 inch (2.7 meter) Length |