

OPTIMA ETF-500 Faucet

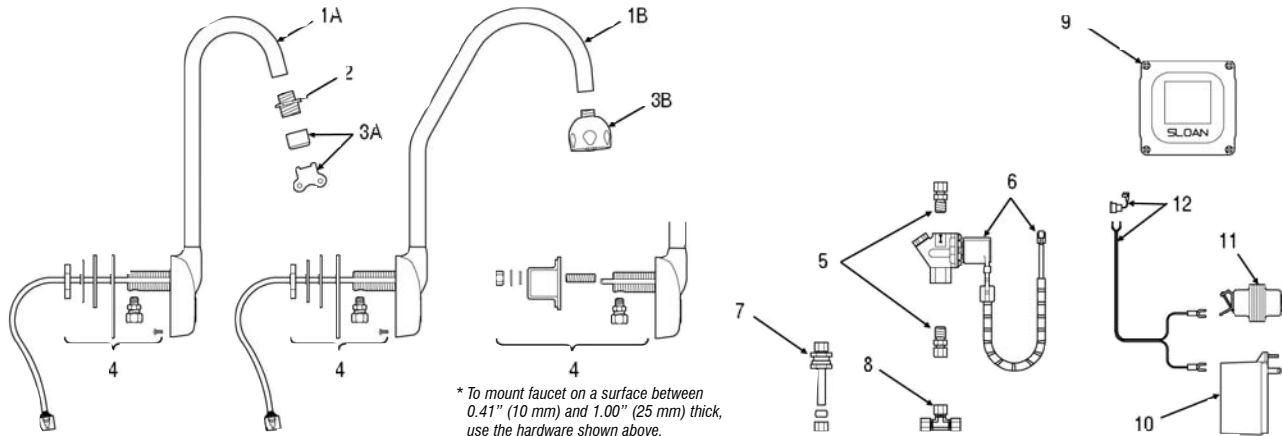

* To mount faucet on a surface between 0.41" (10 mm) and 1.00" (25 mm) thick, use the hardware shown above.

Parts List—ETF-500 Faucet

Item Number	Code Number	Part Number	Description
1A	0365111	ETF-561-A	Faucet/Sensor Assembly with Standard Gooseneck Spout (ETF-500)
1B	0365112	ETF-564-A	Faucet/Sensor Assembly with Surgical Bend Gooseneck Spout (ETF-500-S)
—	0365097	ETF-568-A	Sensor Housing and Cable Assembly for ETF-500 and ETF-500-S Faucets
2	0305784	ETF-178	Aerator Adapter for Spray Heads (not required for AC-55-A Shower Spray Head)
3A	3365091	ETF-1021-A	0.5 gpm (1.9 Lpm) Spray Head with Key (female thread)
	3365090	ETF-1022-A	2.2 gpm (8.3 Lpm) Aerator Spray Head with Key (female thread)
	0305612	ETF-237	2.2 gpm (8.3 Lpm) Laminar Flow Spray Head (female thread)
	0305927	ETF-435	Replacement Key ONLY for ETF-1021-A Spray Head and ETF-1022-A Aerator Spray Head (NOT required for ETF-237 Laminar Flow Spray Head)
3B	0328134	AC-55-A	Shower Spray Head Assembly, 2.2 gpm (8.3 Lpm)
4	0315060	EBF-110-A	Faucet Mounting Kit includes Base Gasket, large Flat Washer, large Lockwasher, large Nut, Mounting Spacer, Mounting Stud, small Flat Washer, small Lockwasher, small Nut, Anti-Rotation Screw, and ETF-591 Compression Fitting Connector (male)
	0365152	ETF-591	1/8" NPT Pipe to 3/8" Tube Male Compression Fitting Connector
5	3365676	ETF-437-A	Single Solenoid Supply Kit includes Supply Tube, two (2) ETF-61 Compression Fittings, Compression Nut, and Ferrule
6	0305849	ETF-370-A	24 VAC Solenoid Valve Assembly includes 18" (153 mm) armored Cable and two (2) Terminal Housings
7	3365001	ETF-470-A	Back Check
8	0305728	ETF-259	3/8" Tee Compression Fitting
9	3365000	ETF-450-A	Control Module Assembly includes splashproof Junction Box and Junction Box Mounting Kit
10	0365534	ETF-233	120V/35VA Plug-In Transformer
11	0345370	EL-248-40	24V/40VA Box Mount Transformer
12	0365001	ETF-458-A	Input Power Cable (Transformer to Control Module) includes Strain Relief and two (2) Terminal Crimp Connectors
13	n/a	EBF-110-A	Old Faucet Mounting Kit included 3/8" Water Supply Tube, Base Gasket, large Flat Washer, large Lockwasher, large Nut, and ETF-547 Compression Fitting Connector (order items 4 and 14 as replacement parts)
14	0365058	ETF-547	1/8" NPT Pipe to 3/8" Tube Female Compression Fitting Connector
—	3305577	ETF-1009-A	Solenoid Valve Repair Kit includes Replacement Filter

FAUCET CABLE EXTENSION CORDS

—	0365042	ETF-1005-26	Faucet to Control Module Extension Cord; 26 inch (0.7 meter) Length
—	0365861	ETF-1005-36	Faucet to Control Module Extension Cord; 36 inch (0.9 meter) Length
—	0305862	ETF-1005-72	Faucet to Control Module Extension Cord; 72 inch (1.8 meter) Length
—	0305863	ETF-1005-108	Faucet to Control Module Extension Cord; 108 inch (2.7 meter) Length
—	0365838	ETF-1003-36	Solenoid to Control Module Extension Cord; 36 inch (0.9 meter) Length
—	0365053	ETF-1003-48	Solenoid to Control Module Extension Cord; 48 inch (1.2 meter) Length
—	0365839	ETF-1003-72	Solenoid to Control Module Extension Cord; 72 inch (1.8 meter) Length
—	0365840	ETF-1003-108	Solenoid to Control Module Extension Cord; 108 inch (2.7 meter) Length

Mounting Kit and Faucet Shank

The new mounting kit (in production since June 1999; part 4 shown on the left) includes parts for installation on both thin and thick surfaces, an ETF-591 male compression fitting, and an anti-rotation screw for installation on sheet metal surfaces less than 0.41" (10 mm) thick. For surfaces between 0.41" (10 mm) and 1.00" (25 mm) thick, use the mounting spacer and mounting stud hardware*. The faucet sensor cable is threaded through a groove on the side of the shank.

The older mounting kit (part 13 shown below) can be identified by a copper supply tube attached to the faucet shank., requires an ETF-547 compression fitting, and threads the faucet sensor cable through the interior of the shank.

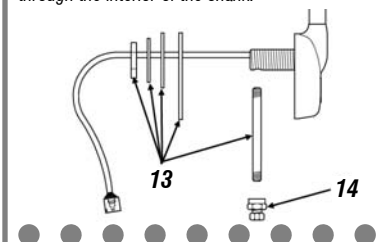

New Base Gasket

The new base gasket (in production since October 1999) is shown at left. An older base gasket design did not have the u-shaped drainage hole.