



T&S BRASS AND BRONZE WORKS, INC.  
 2 SADDLEBACK COVE / P.O. BOX 1088 / TRAVELERS REST, SC 29690  
 PHONE 800-476-4103 FAX 864- 834-3518



Model No.

HG-2S SERIES

Item No.:

REG.#A2601  
ISO #9002

Job Name:

Architect/Engineer Approval:



TO ORDER HG-2S SERIES: HG -   -

EX: HG-D-S

GAS HOSE, 3/4" NPT, (2) SWIVELINKS, 36" LENGTH

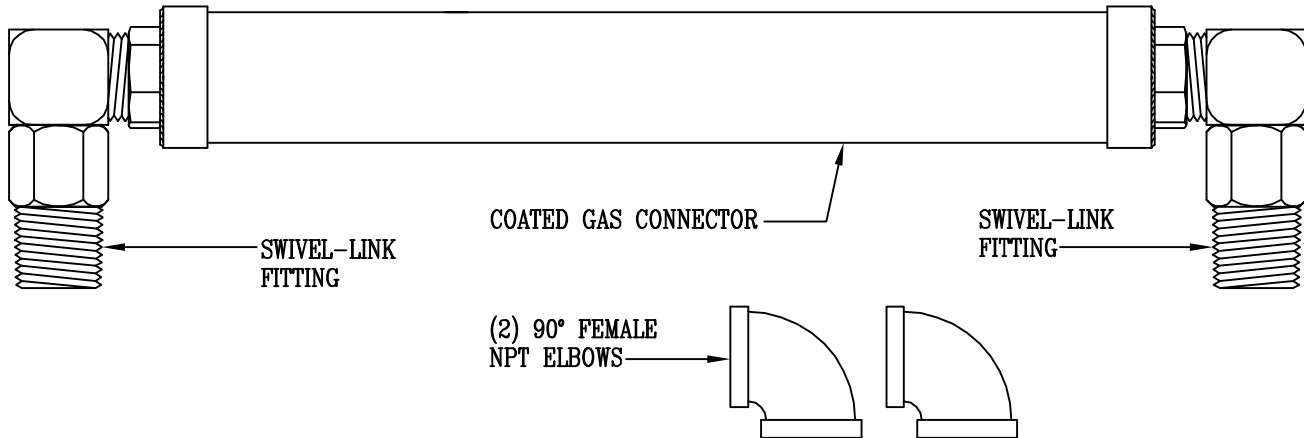

"L" = LENGTH	1/2" NPT
12"	HG-2C-12S
24"	HG-2C-24S
36"	HG-2C-36S
48"	HG-2C-48S
60"	HG-2C-60S
72"	HG-2C-72S

"L" = LENGTH	3/4" NPT
12"	HG-2D-12S
24"	HG-2D-24S
36"	HG-2D-36S
48"	HG-2D-48S
60"	HG-2D-60S
72"	HG-2D-72S

"L" = LENGTH	1" NPT
12"	HG-2E-12S
24"	HG-2E-24S
36"	HG-2E-36S
48"	HG-2E-48S
60"	HG-2E-60S
72"	HG-2E-72S

"L" = LENGTH	1-1/4" NPT
12"	HG-2F-12S
24"	HG-2F-24S
36"	HG-2F-36S
48"	HG-2F-48S
60"	HG-2F-60S
72"	HG-2F-72S

Product Description:  
 SAFE-T-LINK GAS APPLIANCE CONNECTOR:  
 COATED HOSE WITH (2) SWIVEL-LINKS,  
 AND (2) 90 DEGREE ELBOWS

Drawn:

WJS

Checked

ARD

Scale:

1:1

Approved

CA

Date:

3-15-97



**T&S BRASS AND BRONZE WORKS, INC.**  
 2 Saddleback Cove / P.O. Box 1088  
 Travelers Rest, SC 29690

Model No.  
**HG-2-SK Series**

Item No.

Travelers Rest, SC: 800-476-4103 • Simi Valley, CA: 800-423-0150 • Fax: 864-834-3518 • www.tsbrass.com

This Space for Architect/Engineer Approval

Job Name \_\_\_\_\_ Date \_\_\_\_\_

Model Specified \_\_\_\_\_ Quantity \_\_\_\_\_

Customer/Wholesaler \_\_\_\_\_

Contractor \_\_\_\_\_

Architect/Engineer \_\_\_\_\_

# SAFE-T-LINK

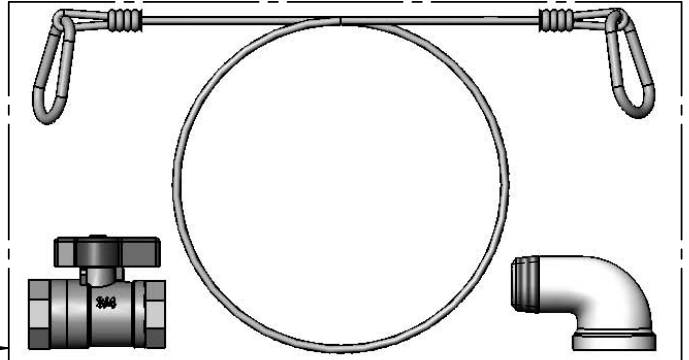
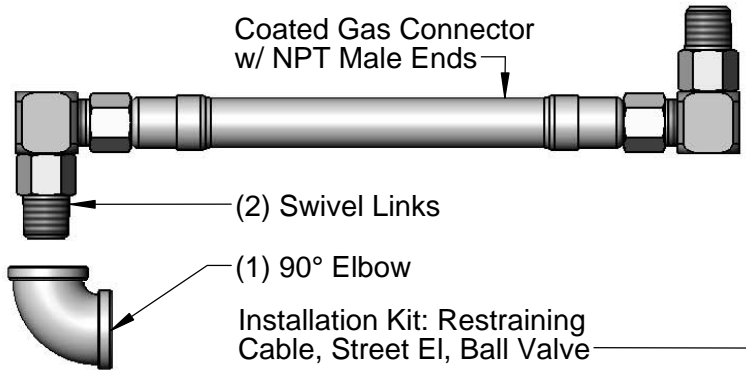

"L" = Length	1/2" NPT
12"	HG-2C-12SK
24"	HG-2C-24SK
36"	HG-2C-36SK
48"	HG-2C-48SK
60"	HG-2C-60SK
72"	HG-2C-72SK

"L" = Length	3/4" NPT
12"	HG-2D-12SK
24"	HG-2D-24SK
36"	HG-2D-36SK
48"	HG-2D-48SK
60"	HG-2D-60SK
72"	HG-2D-72SK

"L" = Length	1" NPT
12"	HG-2E-12SK
24"	HG-2E-24SK
36"	HG-2E-36SK
48"	HG-2E-48SK
60"	HG-2E-60SK
72"	HG-2E-72SK

"L" = Length	1 1/4" NPT
12"	HG-2F-12SK
24"	HG-2F-24SK
36"	HG-2F-36SK
48"	HG-2F-48SK
60"	HG-2F-60SK
72"	HG-2F-72SK

**HG-2-SK Series Product Configurator: HG - 2  -  SK**

Ex: HG - 2  -  SK

Gas Hose, 3/4" NPT Male Ends, 36" Length, (2) Swivel Links, (1) 90° Elbow, (1) Installation Kit

Product Specifications:  
 Safe-T-Link Gas Appliance Connector:  
 Coated Hose w/ NPT Male Ends, Swivel Links, 90° Elbow  
 & Installation Kit

Drawn: <b>DHL</b>	Checked: <b>DMH</b>	Approved: <b>JHB</b>
----------------------	------------------------	-------------------------

Scale: <b>NPT</b>	Date: <b>09/27/12</b>
----------------------	--------------------------



T&S BRASS AND BRONZE WORKS, INC.

2 SADDLEBACK COVE / P.O. BOX 1088 / TRAVELERS REST, SC 29690

PHONE 800-476-4103

FAX 864- 834-3518



REG.#A2601  
ISO #9002

Model No.

HG-2D-48SK-PS

Item No.:

Job Name:

Architect/Engineer Approval:

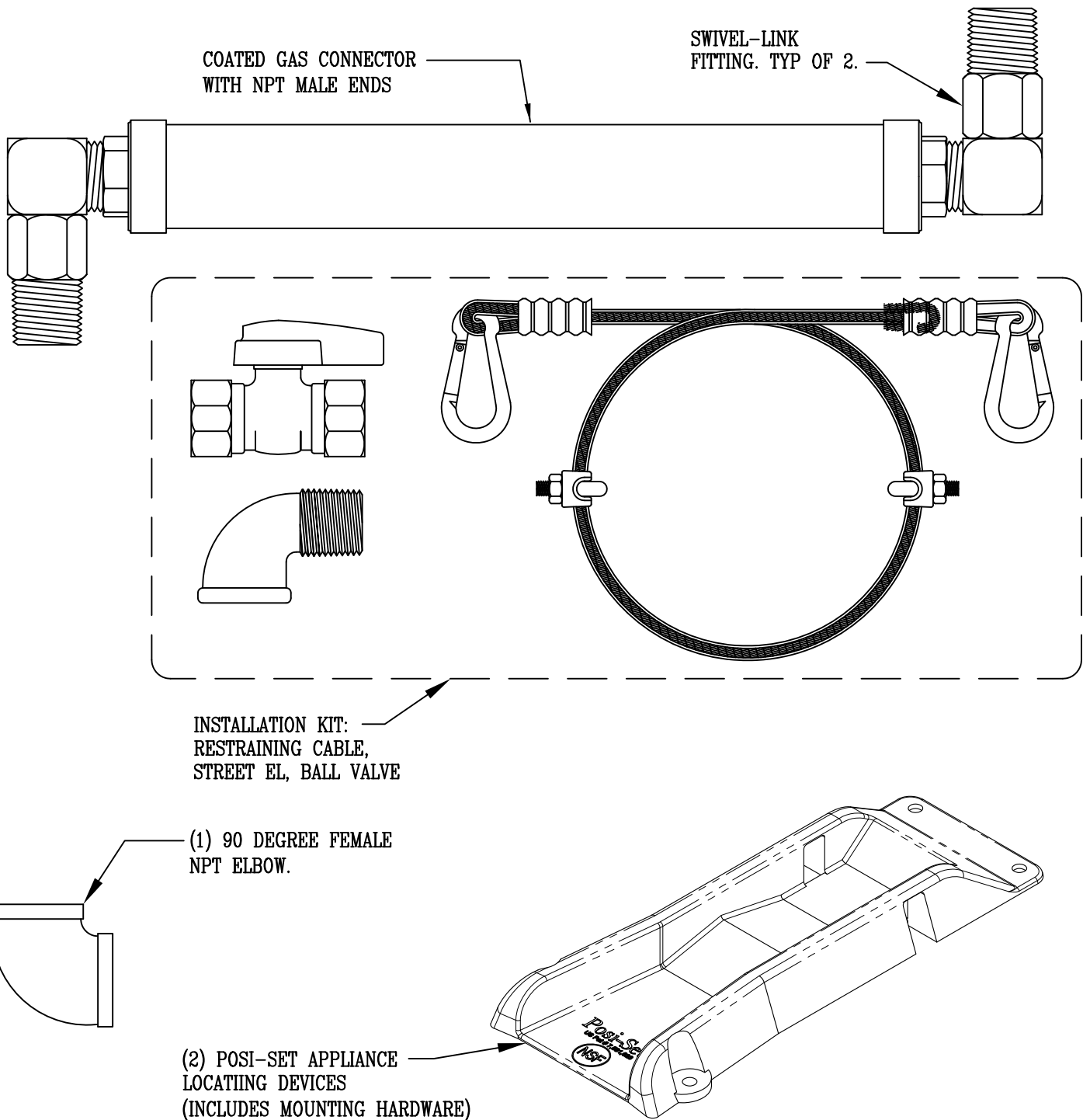

Product Description:  
SAFE-T-LINK GAS APPLIANCE CONNECTOR:  
COATED HOSE FURNISHED w/ SWIVEL LINKS, INSTALLATION  
KIT & POSI-SET APPLIANCE LOCATING SYSTEM

Drawn: DMH	Checked KJG	Scale: NTS
Approved JHB	Date: 11/05/10	